

S E C R E T

Hq RCT 165
APO # 27
18 May 44.

ANNEX "ABLE" to
FO # 20

COMPOSITION OF RCT TROOPS AND BLT'S

1. COMPOSITION OF RCT TROOPS

- a. Regtl Hq and Hq Co 165th Inf
- b. Co Hq Anti-tank Co 165th Inf
- c. Co Hq Cannon Co 165th Inf
- d. Regtl Med Sec 165th Inf
- e. Service Company 165th Inf (less Bn Secs)
- f. Regtl JASCO Team
- g. Co Hq Co C 102nd Engr Bn (C)
- h. Co Hq Co B 102nd Med Bn (Coll)
- i. Co Hq Co C 88th Cml Mort Bn
- j. Co Hq Co D 766th Tk Bn (L)
- k. Ln Party 105th FA Bn

2. COMPOSITION OF BLT 165-1

- a. 1st Bn 165th Inf
- b. 1st Plat Anti-tank Co 165th Inf
- c. 2nd Plat Cannon Co 165th Inf
- d. Bn Med Sec 165th Inf
- e. Bn Sec Serv Co 165th Inf
- f. Bn JASCO Team
- g. 1st Plat Co C 102nd Engr Bn (C)
- h. Plat Co B 102nd Med Bn (Coll)
- i. Ln Party 105th FA Bn

3. COMPOSITION OF BLT 165-2

- a. 2nd Bn 165th Inf
- b. 2nd Plat Anti-tank Co 165th Inf
- c. 3rd Plat Cannon Co 165th Inf
- d. Bn Med Sec 165th Inf
- e. Bn Sec Serv Co 165th Inf
- f. Bn JASCO Team
- g. 2nd Plat Co C 102nd Engr Bn (C)
- h. Plat Co B 102nd Med Bn (Coll)
- i. 1st Plat Co C 88th Cml Mort Bn
- j. 1st Plat Co D 766th Tk Bn (L)
- k. Ln Party 105th FA Bn

S E C R E T

S E C R E T

4. COMPOSITION OF BLT 165-3

- a. 3rd Bn 165th Inf
- b. 3rd Plat Anti-tank Co 165th Inf
- c. 1st Plat Cannon Co 165th Inf
- d. Bn Med Sec 165th Inf
- e. Bn Sec Serv Co 165th Inf
- f. Bn JASCO Team
- g. 3rd Plat Co C 102nd Engr Bn (C)
- h. Plat Co B 102nd Med Bn (Coll)
- i. 3rd Plat Co C 88th Cml Mort Bn
- j. 2nd Plat Co D 766th Tk Bn (L)
- k. Ln Party 105th FA Bn

HART
OMDG

OFFICIAL:

Scheibner
SCHEIBNER
S-3

S E C R E T

SECRET

39

SECRET

AUTH: CG 27 Inf
Div
INITIALS: EDNAK
DATE: 25 May 44

RCT 165
APO # 27
25 May 1944.

OPN PLAN I

IN THE EVENT OPN PLAN I IS ORDERED EXECUTED
IT WILL BECOME FO # 10- FORAGER.

OPN PLAN I - FORAGER

MAPS: Special Terrain Map, 1:62,500, SAIPAN ISLAND.
Special Terrain Map, 1:20,000, SAIPAN ISLAND.

1. a. Summary of enemy information: Annex BAKER atchd.
 - b. (1) 2nd MarDiv, 4th MarDiv: See Annex EASY (Opn Overlay # 1).
 - (2) RCT 105 on right: See Annex EASY (Opn Overlay # 1).
RCT 106, Div Res, afloat.
 - (3) Div Arty in support.
 - (4) Naval Gunfire Support: Annex CHARLIE.
 - (5) Air Support Plan : Annex DOG.
2. a. RCT 165 (Rein) will land on Div O on Beach PURPLE ONE; capture beach exits; seize line A-1 in its Z of action; be prepared for further action in subsequent phases.
 - b. LD, Beaches, Bd, Formation, Objectives, Z of Action: See Annex EASY (Opn Overlay # 1).
3. a. BLT 165-1 land on right (East) half of Beach PURPLE ONE; capture beach exits; seize sector of line A-1 within Z of action; establish contact with RCT 105; be prepared for further opns to North. Co C to be committed only on O of RCT Cmdr.
 - b. BLT 165-2 land on left (West) half of Beach PURPLE ONE; capture beach exits; seize sector of line A-1 within its Z of action; establish contact with Marine forces on left; protect the left flank of the RCT; be prepared for further opns to North.
 - c. BLT 165-3, as RCT Res, will land on right (East) half of Beach PURPLE ONE; assemble at 165B; prepare plans for offensive opns in Z of action of RCT 105; through Z of action of BLT 165-2. Be prepared to protect left flank of the RCT.

SECRET

SECRET

d. I & R Plat be prepared to land on O and perform ren as directed in S-2 Plan (Annex BAKER).

e. Cn Co, less two (2) plats, land on RCT O on Beach PURPLE ONE; be prepared to support the atk from beach head; execute ren and prepare plans to move by either flank, on O, to support the atk in subsequent phases.

f. Plat Co C 88th Cml Mort Bn, land on RCT O on Beach PURPLE ONE; assemble in designated area; be prepared to support the atk; be prepared to smoke HILL 175PQ, on O.

g. Co D 766th Tk Bn (L), less three (3) plats, land on RCT O on Beach PURPLE ONE; be prepared to reconnoiter routes to either flank.

x. (1). EEI - Annex BAKER.

(2) On arrival on phase lines, all units will reorganize, consolidate positions, and be prepared for further adv on RCT O.

(3) Contact right to left.

(4) Combat reports to include contact with adjacent units to be submitted at fifteen (15) minutes to the hour. Loss of contact with adjacent units to be reported immediately.

(5) Landing Force Cmdrs prepare appropriate landing plans, schedules and diagrams.

(6) Locations such as woods, hills, etc., will be referred to by target square; i. e. HILL 175 PQ.

(7) Smoke:

(a) Tactical employment of smoke thru RCT.

(b) Smoke signals as proscribed in Sig Com Plan: Annex GEORGE.

(8) (a) DOG Day - Day of main landings on SAIPAN.

(b) HOW Hour - Time of main landings on SAIPAN.

(c) NAN Hour - Time of all subsequent landings.

(d) KING Hour - Time of all local attacks.

4. Adm O # 1 (Annex ITEM).

5. a. See Sig Com Plan (Annex GEORGE).

b. CP's:

- (1) Afloat: RCT 165 - USS HARRIS
 BLT 165-1 - USS HARRIS
 BLT 165-2 - USS CUSTER
 BLT 165-3 - USS HERALD OF THE MORNING
- (2) Ashore: RCT 165 - See Annex EASY (Opn Overlay # 1).
 Other units - To be reported.

KELLEY
CMDG

OFFICIAL :

Spitzer
COATES
S-3

- ANNEXES:
1. ANNEX ABLE - ORGANIZATION
 2. ANNEX BAKER - INTELLIGENCE PLAN
 3. ANNEX CHARLIE - NAVAL GUNFIRE SUPPORT PLAN (TO BE ISSUED LATER)
 4. ANNEX DOG - AIR SUPPORT PLAN (TO BE ISSUED LATER).
 5. ANNEX EASY - OPNS OVERLAYS
 6. ANNEX FOX - SPECIAL LANDING INSTRUCTIONS
 7. ANNEX GEORGE - SIGNAL COMMUNICATION PLAN
 8. ANNEX HOW - PASS WORDS AND COUNTERSIGNS
 9. ANNEX ITEM - ADM O # 1 w/annexes.

DISTRIBUTION: See List Attached.

SECRET

Opns Overlay #1
Annex EASY
to a company FO #10

RCT 165
25 May 44

Map: Special Terrain
1/20,000, SAIPAN

KELLEY
CMDG

Scatter
COATES
S-3

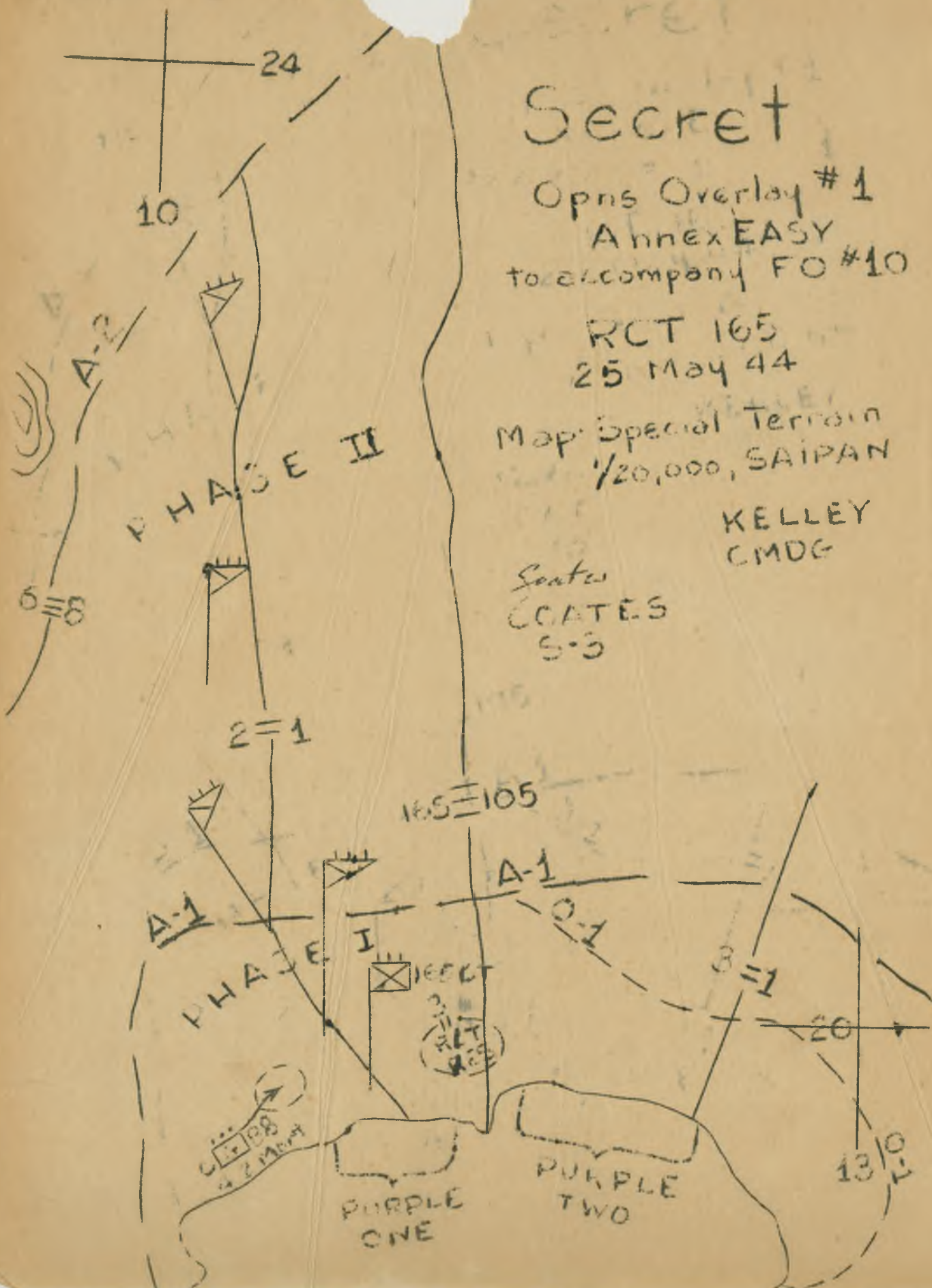

SECRET

AUTH: CG 27 Inf Div
INITIALS: E. J. B.
DATE: 25 May 1944.

RCT 165
APO # 27
25 May 1944.

OPNS PLAN II

IN THE EVENT OPNS PLAN II IS ORDERED EXECUTED
IT WILL BECOME FO # 10 - FORAGER.

OPNS PLAN II - FORAGER

MAPS: Special Terrain Map, 1:62,500, SAIPAN ISLAND
Special Terrain Map, 1:20,000, SAIPAN ISLAND

1. a. Summary of enemy information: Annex BAKER atchd.
 - b. (1) 2nd MarDiv, 4th MarDiv: See Annex EASY (Opns Overlay # 2).
 - (2) RCT 105 on right: See Annex EASY (Opns Overlay # 2).
RCT 106, Div Res, afloat.
 - (3) Div Arty in support.
 - (4) Naval Gunfire Support Plan: Annex CHARLIE.
 - (5) Air Support Plan: Annex DOG.
2. a. RCT 165 (Rein) will land on beach to be designated, move in-
to designated area; organize; establish contact with RCT 105 on
right; be prepared to adv North with left flank on shore line.
 - b. Bd, Assembly areas, LD, Objectives, Z of Action, Phase lines:
See ANNEX EASY (Opns Overlay # 2).
 - c. Formation : According to situation.
 - (1) BLT's in column, in order, BLT 165-2, BLT 165-1, BLT 165-3.
 - (2) BLT's abreast, BLT 165-2 on left, BLT 165-1 on right.
3. a. BLT 165-2 land on left (North) half of designated beach;
move to designated area; organize; be prepared to adv North with
left flank on shore line.
 - b. BLT 165-1 land on right (South) half of designated beach;
move to designated area; organize; be prepared to adv to North. Co C
to be committed only on O of RCT Cndr.
 - c. BLT 165-3 land on right (South) half of designated beach
after BLT 165-1; move to designated area; organize; be prepared to
follow BLT 165-1 to N; prepare plans for offensive action through Z
of action of RCT 105.

SECRET

-1-

SECRET

d. I & R Plat be prepared to land on O and perform ren as directed in S-2 Plan (Annex BAKER).

e. Cn Co, less two (2) plats, land on O; move to designated area; be prepared to support atk.

f. Plat Co C 88th Cml Mort Bn, land on designated beach; assemble in designated area; be prepared to support atk.

x. (1) EBI - Annex BAKER.

(2) On arrival on phase lines, all units will reorganize, consolidate positions, and be prepared for further adv on RCT O.

(3) Prior to crossing LD, 9LT adjacent to RCT 105 will establish contact with RCT 105.

(4) Combat reports to include contact with adjacent units to be submitted at fifteen (15) minutes to the hour. Loss of contact with adjacent units to be reported immediately.

(5) Landing Force Cmdrs prepare appropriate landing plans, schedules and diagrams.

(6) Locations such as woods, hills, etc., will be referred to by target square; i.e. HILL 175 PQ.

(7) Smoke:

(a) Tactical employment of smoke thru RCT.

(b) Smoke signals as prescribed in Sig Com Plan: See Annex GEORGE.

(8) (a) DOG Day - Day of main landings on SAIPAN.

(b) HOW Hour - Time of main landings on SAIPAN.

(c) HAN Hour - Time of all subsequent landings.

(d) KING Hour - Time of all local attacks.

4. Adm O # 1 (Annex ITEM).

5. a. See Sig Com Plan (Annex GEORGE).

b. CP's:

(1) Afloat : RCT 165 - USS HARRIS
 BLT 165-1 - USS HARRIS
 BLT 165-2 - USS CUSTER
 BLT 165-3 - USS HERALD OF THE MORNING

S E C R E T

-3-

S E C R E T

(2) Ashore: RCT 165 - See Annex EASY
Others - To be reported.

KELLEY
CMDG

OFFICIAL:

Go to
CO. TELS
S-3

- ANNEXES:
1. ANNEX ABLE - ORGANIZATION
 2. ANNEX BAKER - INTELLIGENCE
 3. ANNEX CHARLIE - NAVAL GUNFIRE SUPPORT PLAN (TO BE ISSUED LATER)
 4. ANNEX DOG - AIR SUPPORT PLAN (TO BE ISSUED LATER)
 5. ANNEX EASY - OPNS OVERLAYS
 6. ANNEX FOX - SPECIAL LANDING INSTRUCTIONS
 7. ANNEX GEORGE - SIGNAL COMMUNICATION PLAN
 8. ANNEX HOW - PASS WORDS AND COUNTERSIGNS
 9. ANNEX ITEM - ADM O # 1 w/annexes.

DISTRIBUTION : See List Attached.

S E C R E T

-3-

S E C R E T

SECRET

SECRET

AUTH: CG 27 Inf Div
INITIALS: ES/MLG
DATE: 25 May 1944.

RCT 165
APO # 27
25 May 1944.

OPNS PLAN III

IN THE EVENT OPNS PLAN III IS ORDERED EXECUTED
IT WILL BECOME FO # 10 - FORAGER.

OPNS PLAN III - FORAGER

MAPS: Special Terrain Map, 1:62,500, SAIPAN ISLAND.
Special Terrain Map, 1:20,000, SAIPAN ISLAND.

1. a. Summary of enemy information: Annex BAKER.
 - b. (1) 2nd MarDiv, 4th MarDiv: See Annex EASY (Opns Overlay #3).
 - (2) RCT 105 on right: See Annex EASY (Opns Overlay # 3).
RCT 106, Div Res, afloat.
 - (3) Div Arty in support.
 - (4) Naval Gunfire Support Plan: Annex CHARLIE.
 - (5) Air Support Plan: Annex DOG.
2. a. RCT 165 (Rein) will land on Div O on Beach SCARLET ONE; capture beach exits; seize sector of line A-1 within Z of action; be prepared for further action in subsequent phases.
 - b. LD, Beaches, Bd, Formation, Objectives, Z of Action: See Annex EASY (Opn Overlay # 3).
3. a. BLT 165-1 land on right (SW) half of Beach SCARLET ONE; capture beach exits; seize sector of line A-1 within Z of action; establish contact with RCT 105; be prepared for further opns to left (East) of RCT 105. Co C to be committed only on O of RCT Cdr.
 - b. BLT 165-2 land on left (NE) half of Beach SCARLET ONE; capture beach exits; seize sector of line A-1 within Z of action; protect the left flank of the RCT; be prepared for further opns.
 - c. BLT 165-3, as RCT Res, will land on right (SW) half of Beach SCARLET ONE; assemble in designated area; prepare plans for offensive opns in Z of action of RCT 105; through Z of action of BLT 165-2. Be prepared to protect the left flank of the RCT.

SECRET

SECRET

24

A-2

06

A-1

165 ≡ 105

22

08

165CT



105CT

SECRET

Opns Overlay #2
 Finrex EASY
 to accompany FO#10
 RCT 165
 25 May 44.

MAP: Special Terrain Map,
 1/20,000, SAIPAN.

Scater
 COATES
 S-3

KELLEY
 CMDG

108CT



d. I & R Plat be prepared to land on O and perform ren as directed in S-2 Plan (annex BAKER).

e. Cn Co, less two (2) plats, land on RCT O on Beach SCARLET ONE; be prepared to support the atk from beach head; execute ren and prepare plans to move by either flank, on O, to support the atk in subsequent phases.

f. Plat Co C 88th Cml Mort Bn land on RCT O on Beach SCARLET ONE; assemble in designated area; be prepared to support the atk.

g. Co D 766th Tk Bn (L), less three (3) plats, land on RCT O on Beach SCARLET ONE; be prepared to reconnoiter routes to either flank.

x. (1) EEI - Annex BAKER.

(2) On arrival on phase lines, all units will reorganize, consolidate positions and be prepared for further adv on RCT O.

(3) Contact right to left.

(4) Combat reports to include contact with adjacent units, to be submitted hourly, at fifteen (15) minutes to the hour. Loss of contact with adjacent units to be reported immediately.

(5) Locations such as hills, woods, etc., will be referred to by target square; i.e. HILL 175 FQ.

(6) Smoke:

(a) Tactical employment of smoke through RCT.

(b) Smoke signals as prescribed in Sig Com Plan: See Annex GEORGE.

(7) (a) DOG Day - Day of main landings on SAIPAN.

(b) HOW Hour - Time of main landings on SAIPAN.

(c) NAN Hour - Time of all subsequent landings.

(d) KING Hour - Time of all local attacks.

(8) Landing Force Cmdrs prepare appropriate landing plans, schedules and diagrams.

4. Adm O # 1 (Annex ITEM).

5. a. See Sig Com Plan (Annex GEORGE).

b. CP's:

- (1) Afloat: RCT 165 - USS HARRIS
 BLT 165-1 - USS HARRIS
 BLT 165-2 - USS CUSTER
 BLT 165-3 - USS HERALD OF THE MORNING
- (2) Ashore: RCT 165 - See Annex EASY
 Others - To be reported.

KELLEY
 CMDG

OFFICIAL :

(Signature)
 / COATES
 S-3

- ANNEXES :
1. ANNEX ABLE - ORGANIZATION
 2. ANNEX BAKER - INTELLIGENCE
 3. ANNEX CHARLIE - NAVAL GUNFIRE SUPPORT (TO BE ISSUED LATER)
 4. ANNEX DOG - AIR SUPPORT PLAN (TO BE ISSUED LATER)
 5. ANNEX EASY - OPNS OVERLAYS
 6. ANNEX FOX - SPECIAL LANDING INSTRUCTIONS
 7. ANNEX GEORGE - SIGNAL COMMUNICATION PLAN
 8. ANNEX HOW - PASS WORDS AND COUNTERSIGNS
 9. ANNEX ITEM - ADM C # 1 w/annexes

DISTRIBUTION : See List Attached.

A-2

Opns Overlay #3
Annex EASY
to accompany FO #10

RCT 165
25 May 44

Map Special Terrain Map
1/20,000 SAIPAN

KELLEY
CMDG

Seater
COATES
S-3

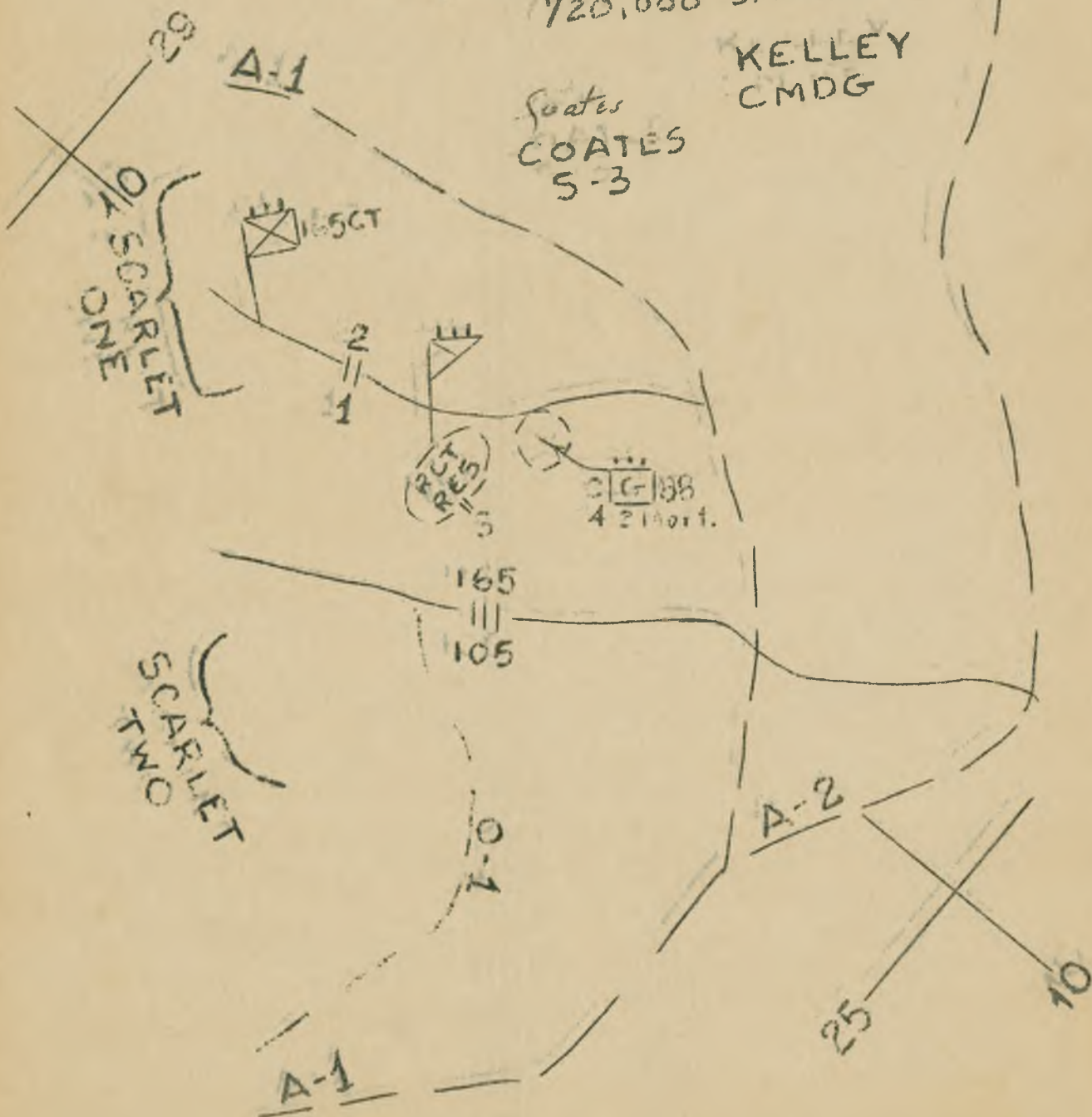

- Secret -

39

AUTH: CG 27 Inf Div
 INITIALS: *CDW*
 DATE: 28 May 1944.

RCT 165
 APO # 27
 28 May 1944.

OPNS PLANS IV to XVIII

IN THE EVENT ANY OF THESE PLANS ARE ORDERED EXECUTED
 IT WILL BECOME FO # 10 - FORAGER.

OPNS PLANS IV to XVIII - FORAGER

MAPS: Special Terrain Map, 1:62,500, SAIPAN ISLAND.
 Special Terrain Map, 1:20,000, SAIPAN ISLAND.

1. The following plans are possible plans for use during the FORAGER Operation. In all plans the scheme of maneuver remains the same; i.e. BLT 165-2 on left, BLT 165-1 on right, BLT 165-3 in RCT Res to land behind BLT 165-1, prepared for opns to either flank.
2. Plan IV : Land on beaches to be designated in support of Mar-Divs; prepared for opns to North, East and South.
3. Plan V (To be used if MarDiv's use Corps alternate plan): Land on Beaches BLUE ONE and TWO, atk and seize ASLITO AIRFIELD in conjunction with RCT 105.
4. Plan VI (To be used if MarDiv's use Corps alternate plan): Land on Beaches RED ONE and TWO, capture BH; prepare to atk North to GARAPAN; RCT 105 capture BH; prepare to atk South to ASLITO AIRFIELD.
5. Plan VII : Not issued.
6. Plan VIII : Land on Beaches BLACK ONE and TWO, capture BH; atk North around East end of MT MARPI to capture airfield, with RCT 106 in support; RCT 105 to protect right flank.
7. Plan IX : Land on Beaches BLACK ONE and TWO, capture BH; protect left flank as RCT 105 and RCT 106 atk South to GARAPAN.
8. Plan X and XI : Not issued.
9. Plan XII : Land on Beaches ORANGE ONE and TWO; capture MT MARPI and rest of BH; atk North to MARPI POINT; RCT 105 to extend BH to South and East.
10. Plan XIII : Land on Beach SCARLET ONE; capture BH; atk South toward MT TAPOTCHAU.
11. Plan XIV : (Same as Plan I) Land on Beach PURPLE ONE; capture line A-1; extend BH to line A-2; capture MT TAPOTCHAU.

12. Plan XV : TINIAN; Land on Beach GREEN ONE and TWO with assistance of RCT 105 (not simultaneous landings); capture town and high ground to North.
13. Plan XVI : GUAM; Land on Beach TUMON LEFT; capture high ground; assist RCT 105 in capture of airfield; support 3rd MarDiv.
14. Plan XVII : TINIAN; Land Beach WHITE ONE; seize Line A-2; prepare to capture AIRFIELD.
15. Plan XVIII : SAIPAN; Land Beach BROWN ONE; seize KAGMLIN POINT; capture high ground North of PURPLE BEACHES; reassemble in Div Res.

KELLEY
CMDG

OFFICIAL :

500-22
COATES
S-3

Secret

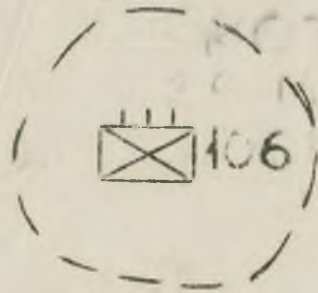
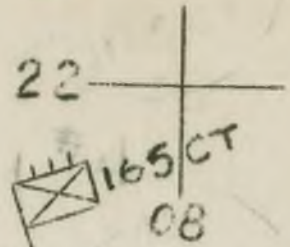

Secret

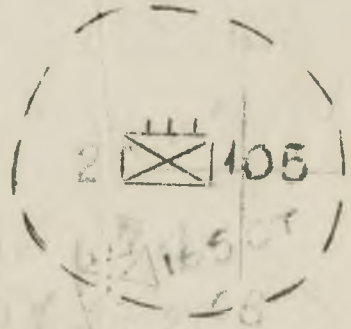

Opns Overlay #4
 Annex EASY
 to accompany FO #10.
 RCT 165
 28 May 14.

MAP: Special Terrain, 1/20,000
 SHIPAN

COATES
 S-3

KELLEY
 CMDG

Secret

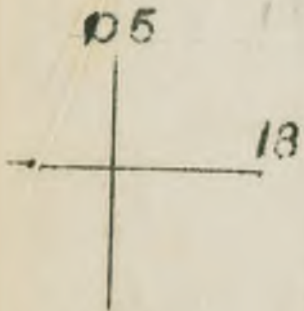

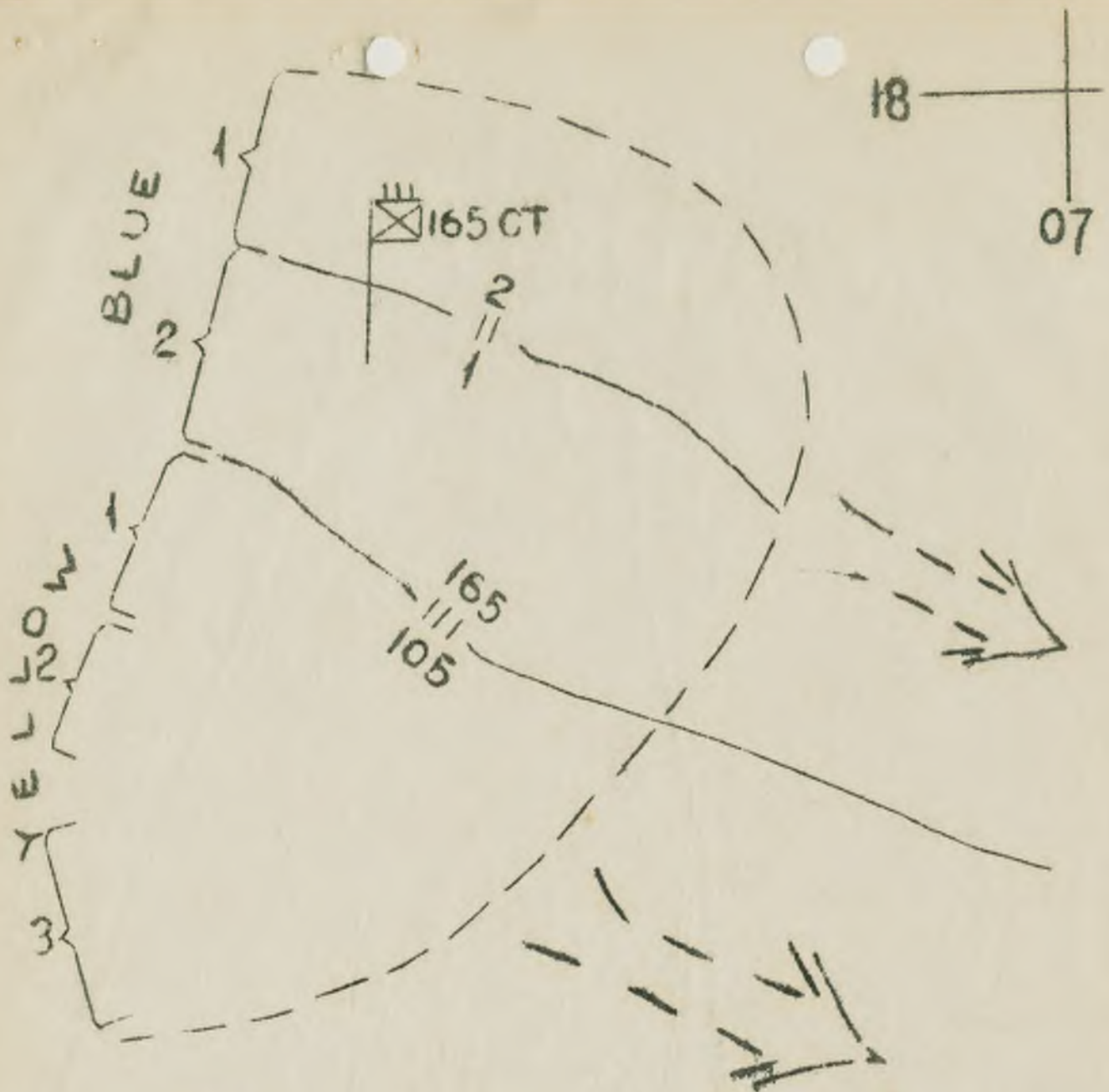

Opns Overlay #5
 Annex EASY
 to accompany FO #10
 RCT 165
 28 MAY 44.

MAP. Special Terrain
 1/20,000 SAIPAN

Secret

Capt
 COATES
 S 3

KELLEY
 CMDG

Secret

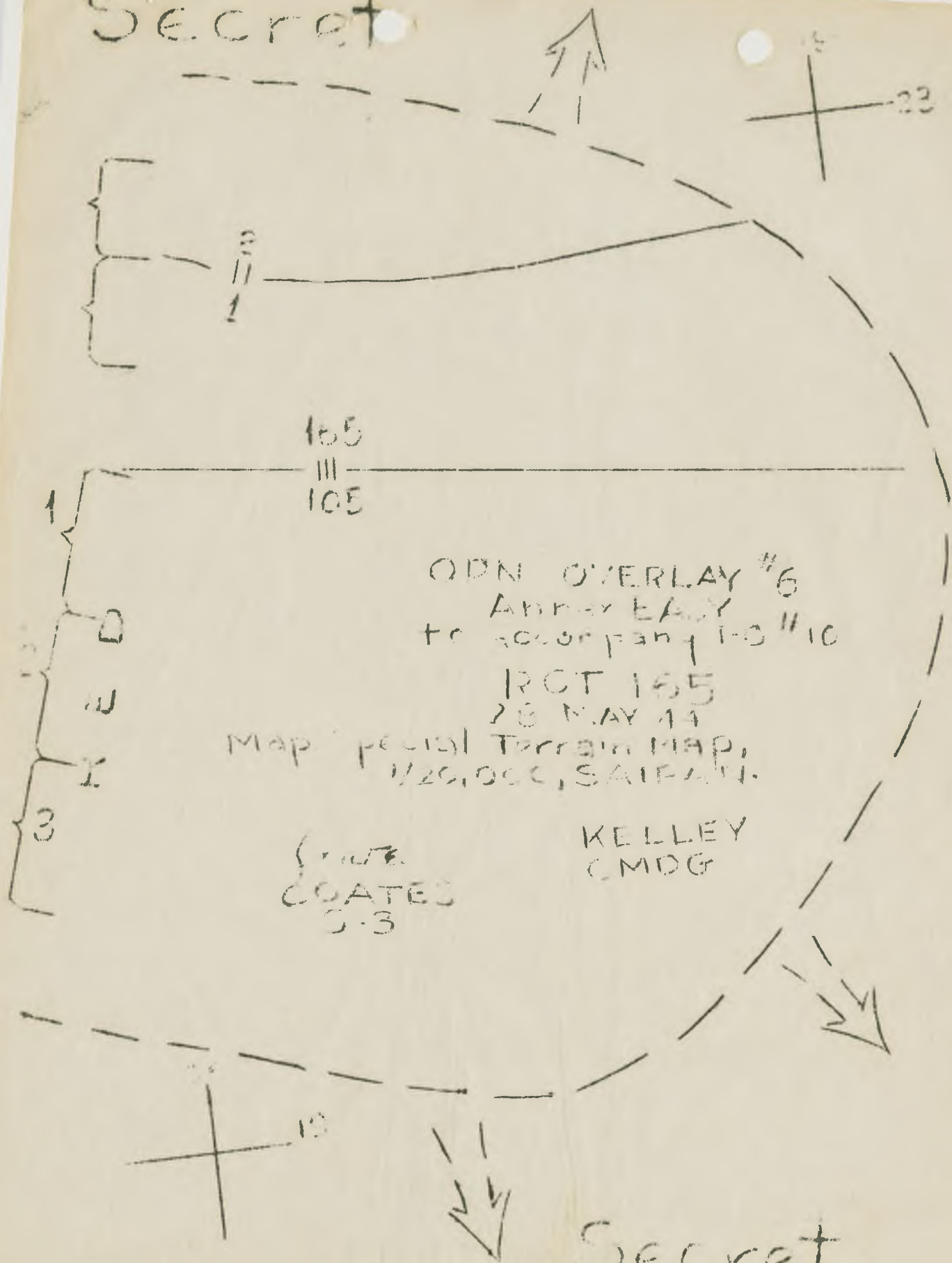

ODN OVERLAY #6
 Area EASY
 to accompany I-C #10
 RCT 165
 28 MAY 44
 Map Special Terrain Map,
 1/20,000, SAIPAN.

KELLEY
 CMDG

COATES
 3-3

Secret

SECRET



FROM BH

PLAN B

CT 100 PROTECTS PLANK AS

CT 165 APIS NE

PLAN S

CT 165 PROTECTS PLANK AS

CT 105 APIS

CT 106 SUPPORTS ATX IN SOUTH PLANS

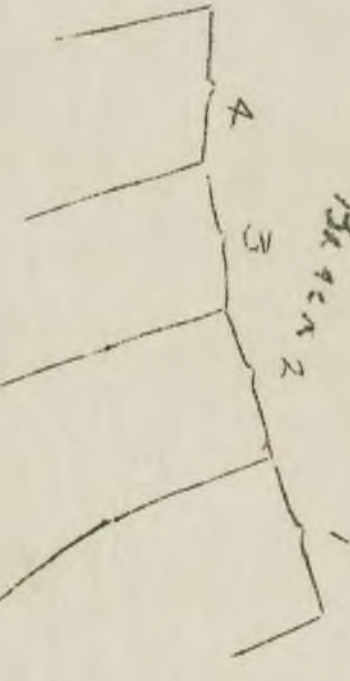

KE...
C100

INITIAL
B.H.

Scates
C.01750
1.3



ORANGE OVERLAY #0
#9

UNDERWAY TO
FO #10 RCL 165

ROMA 74 1700 SAJ AN 12000

Secret

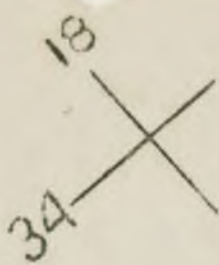

C-1

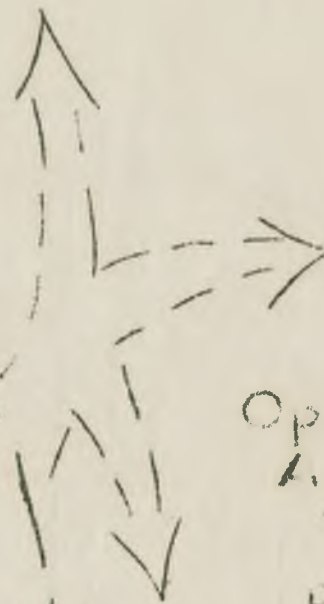

Opn Over #12
A. H. E. Y
TO FO #10

RCT 165
28 MAY 44

MAP SHEET 1/25000

KELLEY
CMUG

Center
DATE
53

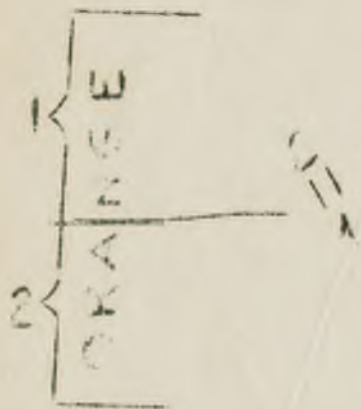

165
111
105

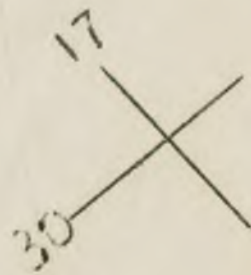

RCT 165 LINES
ON BLACK BEACHES

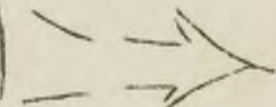

Secret

Secret

Opri Over. # 13
Annex EASY
TO FO # 10

Map: SHIPAN 1/20,000

RCT 165
28 May 44

KELLEY
CMDR

Coats
COATES
S-3

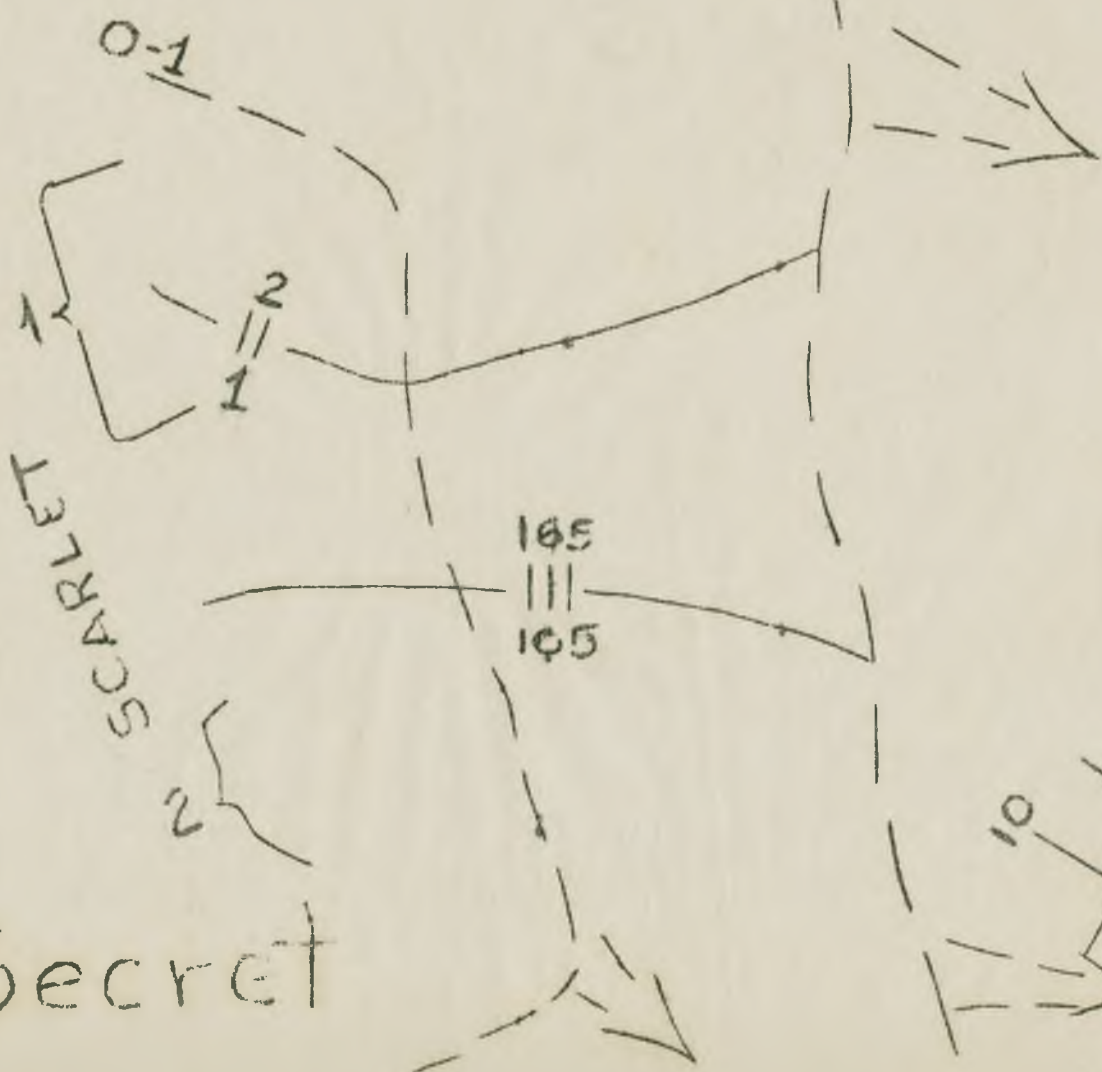
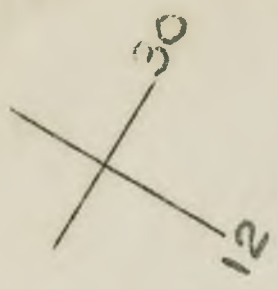

Secret

SECRET

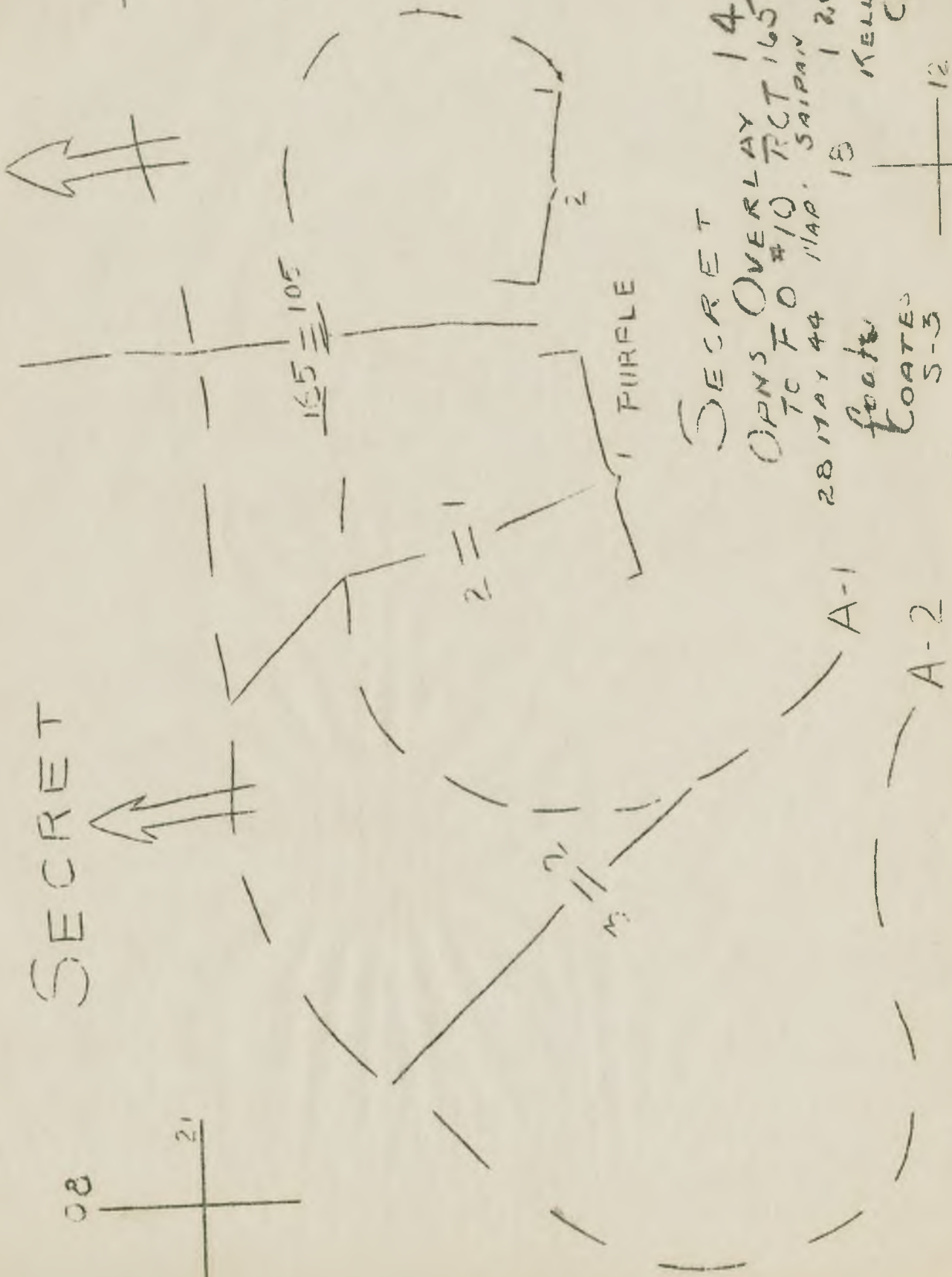
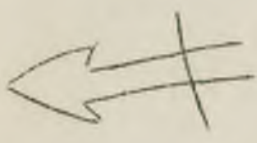

SECRET

OPNS OVERLAY 14
TC FO #10 TECT 165

28 MAY 44 11AP. SAIPAN 18 1 20,000
KELLEY
CMDG

foote
COATES
5-3



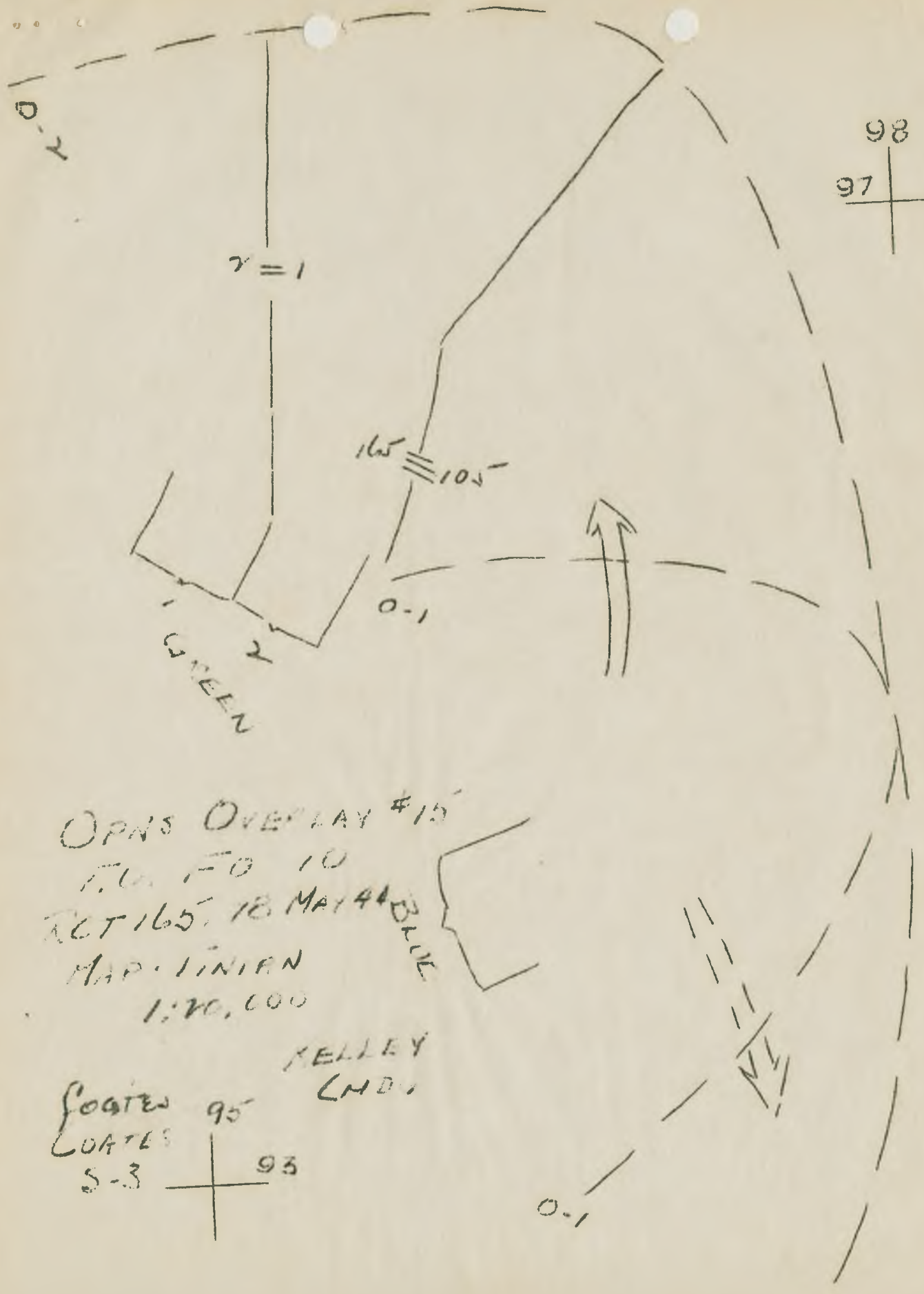

OPNS OVERLAY #15
 T.L. FO 10
 ACT 165, 18 MAY 44
 MAP-TINIAN
 1:70,000

KELLEY
 CMD.

FOATES 95
 COATES
 S-3

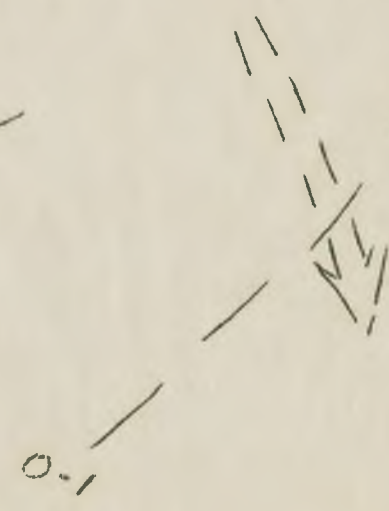
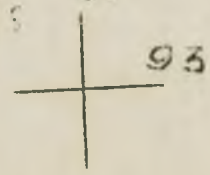

Secret
Opns Overlay # 16
Annex EASY
to FO # 10.
MAP GUAM 1/62, 500
RCT 165
28 MAY 44.

Source
COATES
S-3

KELLEY
CMDG

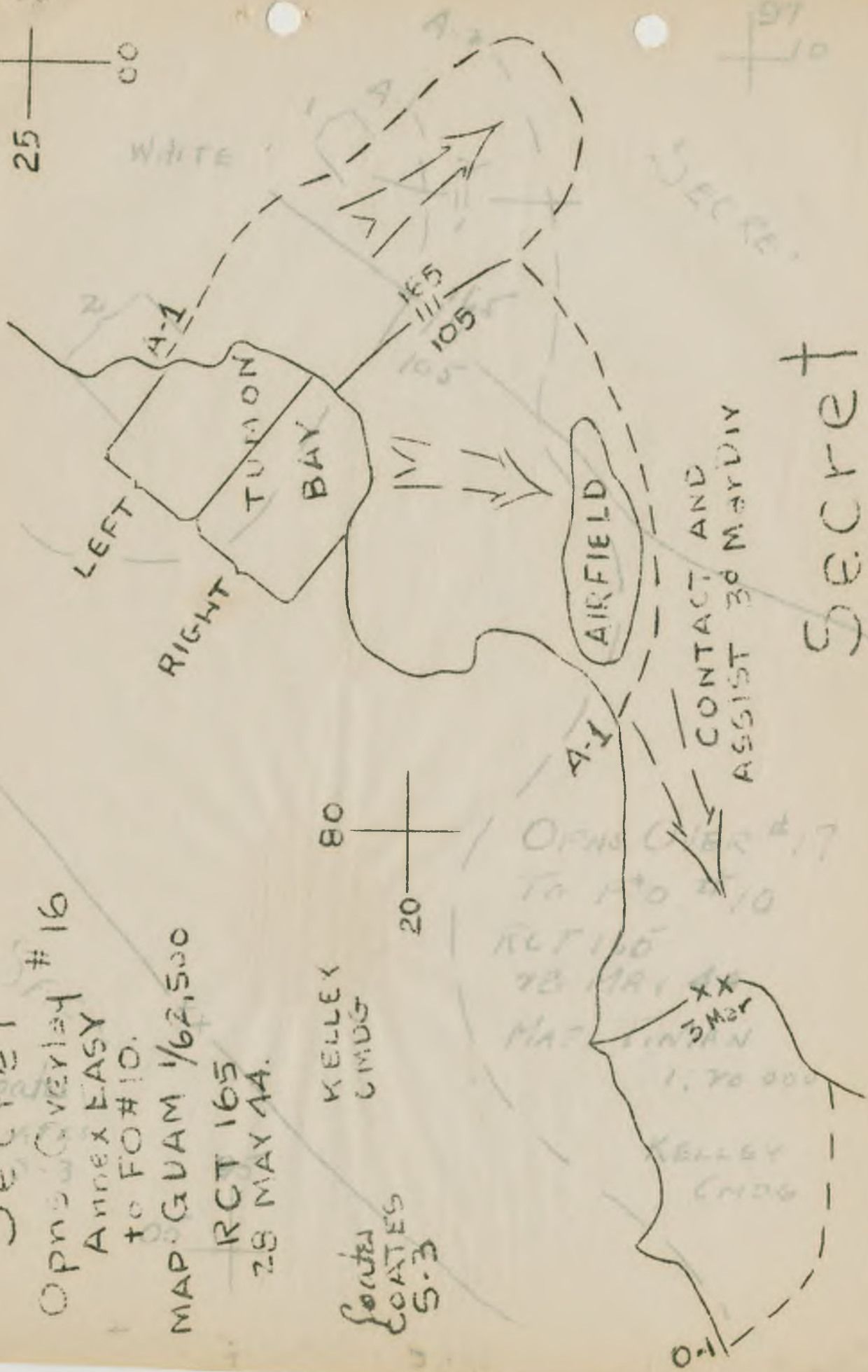
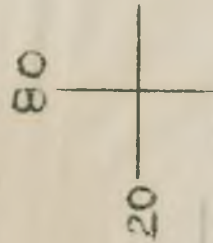

CONTACT AND
ASSIST 3d MARDIV

Secret

SECRET

OPNS OVERLAY # 17
TO HQ # 10
RCT 165
28 MAY 44
MAP GUAM
1:70,000
KELLEY
CMDG

0-1

SECRET



BROWN

105

III

165

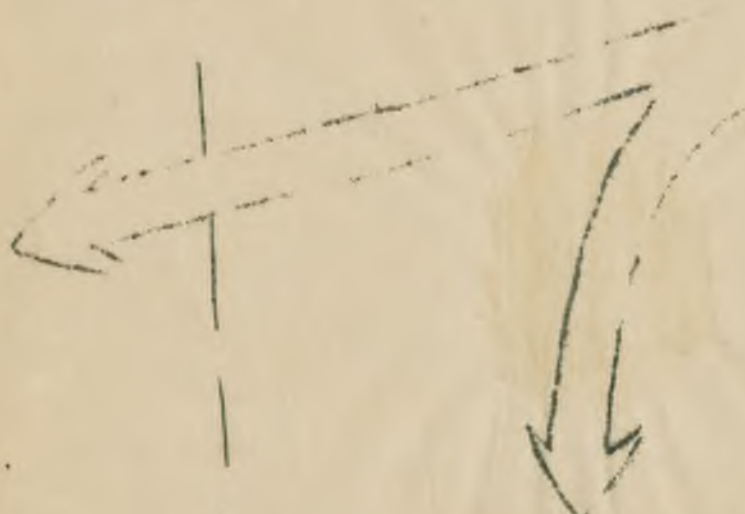
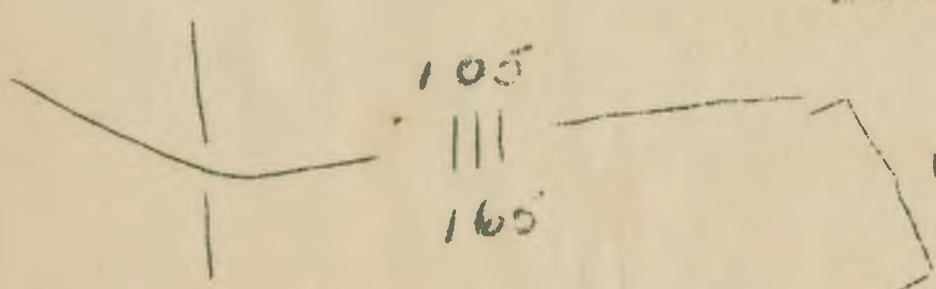

OPNS OVER #18
 TO FO #10
 REC 100' 28 MAY 44
 MAP SAIPAN 1:70000

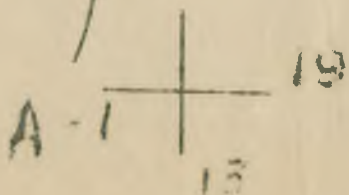

Coates KELLEY
 Coates CHOU
 5-3

SECRET

39

AUTH: CG 27th Inf Div
 INITIALS:
 DATE: 25 May 1944.

RCT 165
 APC # 27
 25 May 1944.

OPNS PLAN # XIX-A

IN THE EVENT OPNS PLAN # IS ORDERED EXECUTED
 IT WILL BECOME FO # 10 - FORAGER.

OPNS PLAN # XIX - FORAGER

MAPS: Special Terrain Map, 1:62,500, SALVAN ISLAND.
 Special Terrain Map, 1:20,000, SALVAN ISLAND.

1. a. Summary of enemy information: Annex LAKER.
 - b. (1) 2nd MarDiv, 4th MarDiv: See Annex EASY (Opns Overlay # 19).
 - (2) Div Arty in support.
 - (3) Naval Gunfire Support: Annex CHARLIE.
 - (4) Air Support Plan: Annex D.G.
2. a. RCT 165 (main) will land on beaches to be designated; move to designated area; organize; establish contact with 2nd and 4th MarDiv's; be prepared to adv East toward MAGICIENNE BAY.
 - b. Beaches, Bd, Assembly areas, LD, Objectives, Z of Action, Phase Lines, Formation: See Annex EASY (Opns Overlay # 19).
3. a. BLT 165-2 land on left (North) half of designated beach; move to assembly area; organize; establish contact with 2nd MarDiv on left; be prepared to adv East.
 - b. BLT 165-1 land on right (South) half of designated beach; move to assembly area; organize; establish contact with 4th MarDiv on right; be prepared to adv East.
 - c. BLT 165-3 land on right (South) half of designated beach; move to assembly area; organize; be prepared to follow behind BLT 165-2; prepare plans for use on either flank.
 - d. I & R Plat be prepared to land on C and perform ren as directed in S-2 Plan (Annex LAKER).
 - e. Cn Co, less two (2) platoes, land on C; move to designated area; be prepared to support atk.

f. 11at Co C 88th Cml Mort Bn, land on designated beach; assemble in designated area; be prepared to support atk.

x. (1) EEI - Annex BAKER

(2) On arrival on phase lines, all units will reorganize, consolidate positions and be prepared to adv on RCT O.

(3) Contact right to left.

(4) Combat reports to include contact with adjacent units, to be submitted hourly at fifteen (15) minutes to the hour. Loss of contact with adjacent units will be reported immediately.

(5) Landing Force Cmdrs prepare appropriate landing plans, schedules and diagrams.

(6) Locations such as woods, hills, etc., will be referred to by target square; i.e. HILL 175 PQ.

(7) Smoke:

(a) Tactical employment of smoke through RCT.

(b) Smoke signals as prescribed in Sig Com Plan: See Annex GEORGE.

(8) (a) DOG Day - Day of main landings on SAIPAN.

(b) HOW Hour - Time of main landings on SAIPAN.

(c) NAN Hour - Time of all subsequent landings.

(d) KING Hour - Time of all local attacks.

4. Adm O # 1 (Annex ITEM).

5. a. See Sig Com Plan (Annex GEORGE).

b. CP's:

(1) Afloat: RCT 165 - USS HARRIS
 BLT 165-1 - USS HARRIS
 BLT 165-2 - USS CUSTER
 BLT 165-3 - USS HERALD OF THE MORNING

(2) Ashore : RCT 165 - See Annex ENSY (Opn Overlay # 1)
 Others -, To be reported. 19

KELLEY
CMDG

CONTROL :

See
COATES
S-3

- ANNEXES :
1. ANNEX ABLE - ORGANIZATION
 2. ANNEX BAKER - INTELLIGENCE
 3. ANNEX CHARLIE - NAVAL GUNFIRE SUPPORT (TO BE ISSUED
LATER)
 4. ANNEX DOG - AIR SUPPORT PLAN (TO BE ISSUED LATER)
 5. ANNEX EASY - OPNS OVERLAYS
 6. ANNEX FOX - SPECIAL LANDING INSTRUCTIONS
 7. ANNEX GEORGE - SIGNAL COMMUNICATIONS PLAN.
 8. ANNEX HOW - PASS WORDS AND COUNTERSIGNS.
 9. ANNEX ITEM - ADM O # 1 w/annexes.

DISTRIBUTION : See Attached List.

SECRET

RCT 165
25 MAY 44

Opns

OVERLAY # 19

ANNEX EASY

TO ACCOMPANY F-0 #10

MAP SPECIAL TERRAIN MAP, 1:20,000, SHIPAN I

Goates
GOATES
S-3

KELLEY
CMDG

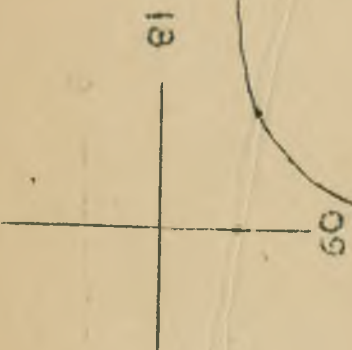
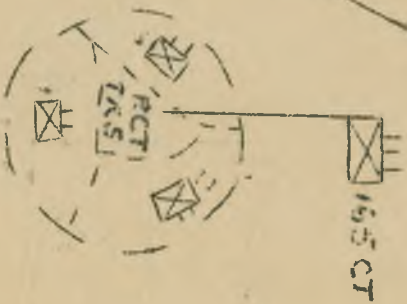
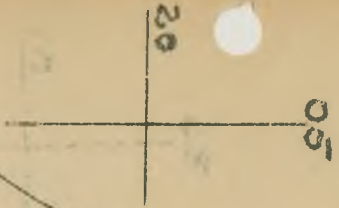

SECRET

RCT 165
APO # 27
25 May 1944.

DISTRIBUTION

BLT 165-1	(2)	Med Det 165 Inf	(1)
BLT 165-2	(2)	Regtl JASCO Team	(2)
BLT 165-3	(2)	I & R Plat 165 Inf	(1)
ACT 105	(1)	Plat Co C 88th Cml	
RCT 106	(1)	Mort Bn	(1)
CG 27 Inf Div	(5)	152 Engr Bn	(1)
Cdr TransDiv 32	(5)	S-4 165 Inf	(1)
105 PA Bn	(1)	S-2 165 Inf	(1)
Co C 102 Engr Bn	(1)	Com O 165 Inf	(1)
Co B 102 Med Bn	(1)	S-1 Journal	(1)
Co D 766 Tk Bn	(1)	S-3 File	(4)
Hq Co 165 Inf	(1)		
Serv Co 165 Inf	(1)		
AT Co 165 Inf	(1)		
Cn Co 165 Inf	(1)		

May Reynolds will set 5042

S E C R E T

NOTE: CHANGE OPNS PLAN XIX
PREVIOUSLY ISSUED TO
READ - OPNS PLAN XIX-A

AUTH: CG 27th Inf Div
INITIALS: _____
DATE: 7 June 1944.

RCT 165
APO # 27
7 June 1944.

OPN PLAN XIX
IN THE EVENT THAT OPN PLAN XIX IS ORDERED EXECUTED
IT WILL BECOME FO # 10 - FORAGER.

OPN PLAN XIX - FORAGER

MAPS: Special Terrain Map, 1:62,500, TINIAN ISLAND.
Special Terrain Map, 1:20,000, TINIAN ISLAND.

1. a. Summary of enemy information: See Annex BAKER.
- b. (1) 27th Inf Div lands in assault on TINIAN ISLAND.
 RCT 105 in center on Beach GREEN TWO.
 RCT 106 on right on Beach BLUE (See Annex EASY, Opn Overlay # 20).
- (2) Div Arty in support.
- (3) Naval Gunfire Support: Annex CHARLIE.
- (4) Air Support: Annex DOG.
2. a. RCT 165 (Rein) will land on Beach GREEN ONE; capture the beach exits; seize TINIAN TOWN and the sector of the line O-1 in its Z of action; be prepared for further ops to the North.
- b. LD, Beaches, Bd, Formation, Objectives, Z of Action: See Annex EASY (Opn Overlay # 20).
3. a. BLT 165-1 land on right (SE) half of Beach GREEN ONE; capture the beach exits; seize sector of line O-1 in its Z of action; establish contact with RCT 105 on right; be prepared for further action to the North.
- b. BLT 165-2 land on left (NW) half of Beach GREEN ONE; capture the beach exits; seize sector of line O-1 in its Z of action; be prepared for further action to the North.
- c. BLT 165-3, in Res, land on Beach GREEN ONE; mop up sector of TINIAN TOWN in Z of action of RCT 165; assemble in designated area prepared to support the advance of the RCT.

S E C R E T

S E C R E T

- 2 -

d. I & R Plat 165th Inf, land on RCT 0, execute rcm as directed in S-2 Plan (Annex BAKER).

e. Plat Co C 88th Cml Mort Bn land on RCT 0; assemble in designated area; be prepared to support the atk.

f. Cn Co, less two (2) plats, land on RCT 0 prepared to support the atk from beachhead; prepare plans to assist BLT 165-3 in mopping up of TINIAN TOWN.

g. Co D 766th Tk Bn (L), less three (3) plats, land on RCT 0; prepare plans to assist BLT 165-3 in mopping up TINIAN TOWN.

h. Co C 102nd Engr Bn, less three (3) plats, land on RCT 0; prepare plans to assist BLT 165-3 in mopping up TINIAN TOWN.

i. 152nd Engr Bn (C) be prepared to assist in mopping up TINIAN TOWN.

x. (1) EEI - Annex BAKER.

(2) On arrival on phase lines, all units will reorganize, consolidate positions, and be prepared for further adv on RCT 0.

(3) Contact right to left.

(4) Combat reports to include contact with adjacent units to be submitted hourly, at fifteen (15) minutes to the hour. Loss of contact with adjacent units to be reported immediately.

(5) BLT Cndrs prepare appropriate landing diagrams, plans and schedules.

(6) Assault BLT's, upon landing, will move to capture line A-1 as rapidly as possible. Support units will mop up behind assault units.

(7) BLT's will report immediately when 1st Wave has landed; when all assault waves have landed; when line A-1 has been occupied.

4. Adm O # 1 (Annex ITEM).

5. a. See Sig Com Plan: Annex GEORGE.

b. CP's:	Afloat	Ashore
RCT 165	USS HARRIS	See Annex EASY
BLT 165-1	USS HARRIS	To be reported
BLT 165-2	USS CUSTER	To be reported
BLT 165-3	USS HERALD OF THE	To be reported

MORNING

- 2 -

S E C R E T

S E C R E T

-3-

KELLEY
CMDG

OFFICIAL:

Coates
COATES
S-3

- ANNEXES:**
1. ANNEX ABLE - TASK ORGANIZATION
 2. ANNEX BAKER - INTELLIGENCE
 3. ANNEX CHARLIE - NAVAL SUPPORT - (TO BE ISSUED LATER)
 4. ANNEX DOG - AIR SUPPORT PLAN (TO BE ISSUED LATER)
 5. ANNEX EASY - OINS OVERLAYS
 6. ANNEX FOX - SPECIAL LANDING INSTRUCTIONS
 7. ANNEX GEORGE - SIGNAL COMMUNICATIONS PLAN.
 8. ANNEX HOW - PASS WORDS AND COUNTERSIGNS.
 9. ANNEX ITEM - APM O # 1

DISTRIBUTION : See Attached List.

OFFICIAL:

-3-

S E C R E T

SECRET

FBL

A-2

A-1

1300 89
4 24

1300 89
4 24

165

165 105

GREEN 1
GREEN 2

A-2

A-1

97

94

BLUE

OPN OVERLAY # 20

ANNEX EASY # 2

FO # 10 RCT 165

10 JUNE 44
MAP: TINIAN 1:20,000

FOOTES
COATES
S-3

KELLEY
C1406

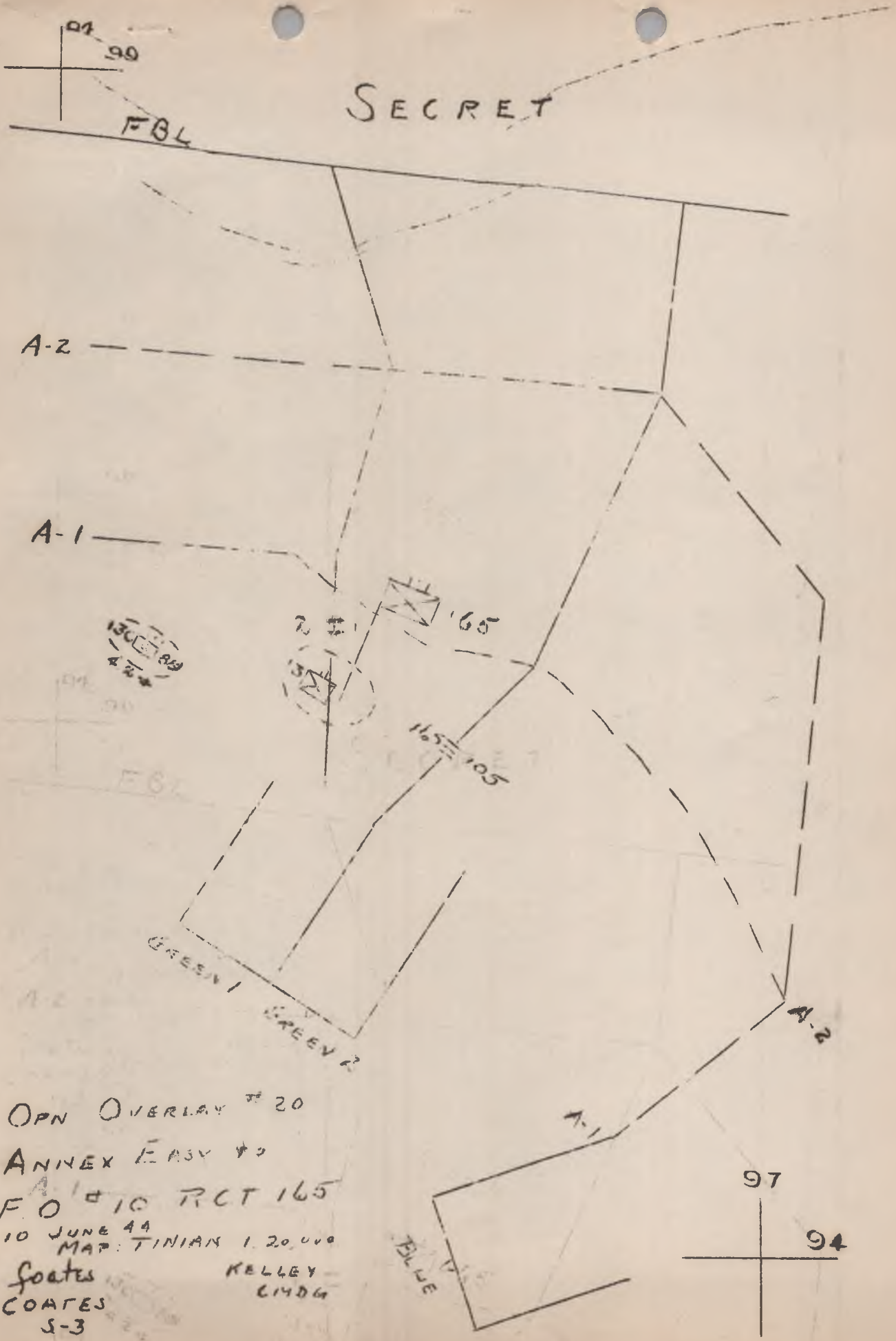

AUTH: CG 27th Inf Div

INITIALS: _____

DATE : 9 June 1944.

RCT 165

APC # 27

9 June 1944.

OPN PLAN XX

IN THE EVENT THAT OPN PLAN XX IS ORDERED EXECUTED
IT WILL BECOME FO # 10 - FORAGER.

OPN PLAN XX - FORAGER

MAPS: Special Terrain Map, 1:62,500, TINIAN ISLAND
Special Terrain Map, 1:20,000, TITIAN ISLAND.

1. a. Summary of army interdictions: Annex SAKUR.

b. (1) 27th Inf Div (Rein) in conjunction with the Joint Expeditionary Force, will land in assault on Beach BLUE.

RCT 165 on left half of Beach BLUE.

RCT 105 on right half of Beach BLUE.

RCT 106 in fighting reserve.

(2) Div Arty (less Bns atchd to RCT's) land on O, support atk of RCT 165.

(3) Naval Gunfire Support: Annex CHARLIE.

(4) Air Support: Annex DOG.

2. a. RCT 165 (Rein) will land on left half of Beach BLUE; capture beach exits; seize line A-1 within its Z of action; be prepared for further opns to seize line A-2 and protect DBH.

b. LD, Beaches, Bd, Formation, Objectives, Z of Action: See Annex EASY (Opn Overlay # 21).

3. a. BLT 165-1 land on left center of Beach BLUE; capture beach exits; seize sector of line A-1 in its Z of action; establish contact with RCT 105 on right; be prepared for further opns to the NW.

b. BLT 165-2 land on left portion of Beach BLUE; capture the beach exits; seize sector of line A-1 in its Z of action; be prepared for further action to the NW.

c. BLT 165-3, in Res. land on Beach BLUE; assemble in designated area; prepare to support the advance of the RCT; be prepared for further action to the NW.

SECRET

-2-

d. I & R Plat 165th Inf, land on RCT 0, execute run as directed in S-2 Plan (Annex BAKER).

e. Plat Co C 88th Cml Mort Bn, land on RCT 0, assemble in designated area; be prepared to support the atk.

f. Cn Co, less two (2) plats, land on RCT 0 prepared to support the atk from beachhead; prepare plans to assist in mopping up TINIAN TOWN.

g. Co D 766th Ik Bn (L), less three (3) plats, land on RCT 0, prepare plans to assist in mopping up TINIAN TOWN.

h. Co C 102nd Engr Bn, less three (3) plats, land on RCT 0, prepare plans to assist in mopping up TINIAN TOWN.

i. 152nd Engr Bn (C) be prepared to assist in mopping up TINIAN TOWN.

x. (1) EEI - Annex BAKER.

(2) On arrival on phase lines, all units will reorganize, consolidate positions and be prepared for further adv on RCT 0.

(3) Contact right to left.

(4) Combat reports to include contact with adjacent units too be submitted hourly, at fifteen minutes (15) to the hour. Loss of contact with adjacent units to be reported immediately.

(5) BLT Cmdrs prepare appropriate landing diagrams, plans and schedules.

(6) Assault BLT's, upon landing, will move to capture line A-1 as rapidly as possible. Support units will mop up behind assault units.

(7) BLT's will report immediately when: 1st wave has landed; when all assault waves have landed; when line A-1 has been occupied.

4. Adm O: # 1 (Annex ITEM).

5. a. See Sig Com Plan (Annex GEORGE).

b. CP's: to assist in, Afloat Ashore

1. RCT: 165	USS HARRIS	See Annex EASY
BLT 165-1	USS HARRIS	To be reported
BLT 165-2	USS CUSTER	To be reported
x. BLT: 165-3	USS HERALD OF THE MORNING	To be reported

(8) On arrival on phase lines, all units will reorganize, consolidate positions and be prepared for further adv on RCT 0.

KELLEY
CMDG

OFFICIAL:

Coates
COATES
S-3

- ANNEXES: 1. ANNEX ABLE - TASK ORGANIZATION
 2. ANNEX BAKER - INTELLIGENCE
 3. ANNEX CHARLIE - NAVAL GUNFIRE SUPPORT - (TO BE ISSUED LATER)
 4. ANNEX DOG - AIR SUPPORT PLAN (TO BE ISSUED LATER)
 5. ANNEX EASY - OPNS OVERLAYS
 6. ANNEX FOX - SPECIAL LANDING INSTRUCTIONS
 7. ANNEX GEORGE - SIGNAL COMMUNICATIONS PLAN.
 8. ANNEX HOW - PASS WORDS AND COUNTERSIGNS.
 9. ANNEX ITEM - ADM O # 1

DISTRIBUTION : See Attached List.

KELLEY
CMDG

OFFICIAL:

Coates
COATES
S-3

- ANNEXES: 1. ANNEX ABLE - TASK ORGANIZATION
 2. ANNEX BAKER - INTELLIGENCE
 3. ANNEX CHARLIE - NAVAL GUNFIRE SUPPORT - (TO BE ISSUED LATER)
 4. ANNEX DOG - AIR SUPPORT PLAN (TO BE ISSUED LATER)
 5. ANNEX EASY - OPNS OVERLAYS
 6. ANNEX FOX - SPECIAL LANDING INSTRUCTIONS
 7. ANNEX GEORGE - SIGNAL COMMUNICATIONS PLAN.
 8. ANNEX HOW - PASS WORDS AND COUNTERSIGNS.
 9. ANNEX ITEM - ADM O # 1

DISTRIBUTION : See attached list.

SECRET

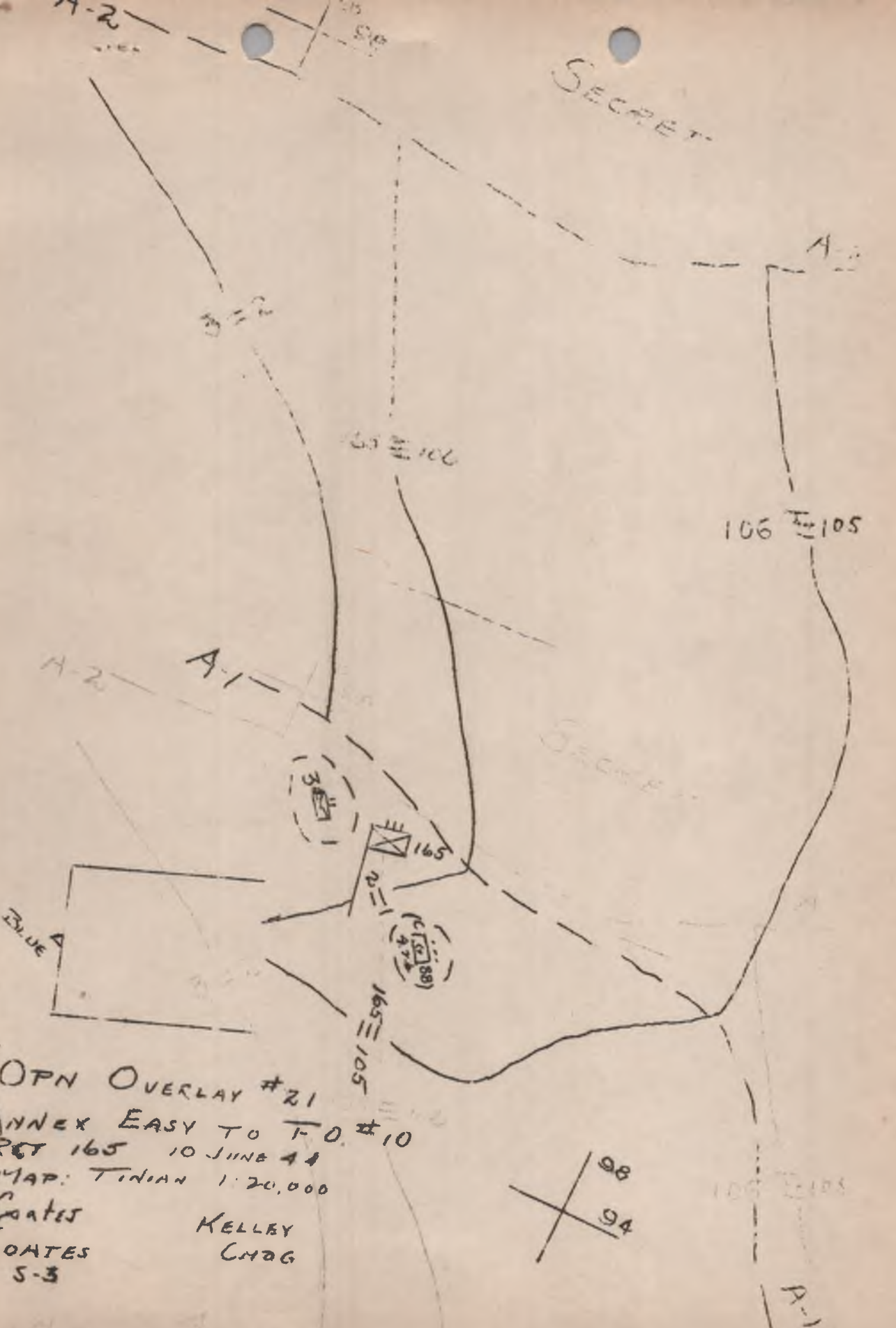

OPN OVERLAY #21
 ANNEX EASY TO F.O. #10
 RET 165 10 JUNE 44
 MAP: TINIAN 1:20,000
 FOATES
 COATES 5-3
 KELLEY
 CMDG

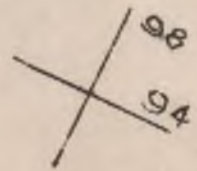

AUTH: CG 27th Inf Div
 INITIALS: E. J. McLo
 DATE: 25 May 1944.

RCT 165
 APO # 27
 25 May 1944.

ANNEX "ABLE" to accompany FO # 10 - FORAGER.

TASK ORGANIZATION

1. COMPOSITION OF RCT TROOPS

Hq & Hq Co 165th Infantry
 AT Co 165th Infantry (Less four (4) plats)
 Cn Co 165th Infantry (Less two (2) plats)
 Serv Co 165th Infantry (Less det's)
 Med Det 165th Infantry (Less B Med Sec's)
 Co D 766th Tk Bn (L) (Less three (3) plats)
 Co C 102nd Engr Bn (C) (Less three (3) plats)
 Co B 102nd Med Bn (Coll) (Less three (3) plats)
 105th FA Bn (Less three (3) btry's)
 Regtl JASCO Team
 Plat Co C 88th Cml Mort Bn
 604th Graves Registration
 95th Bomb Disposal Squad
 152nd Engr Bn (C) (Less three (3) Co's)
 Det 727th Ord Co

2. COMPOSITION OF BLT 165-1

1st Bn 165th Infantry
 1st Bn Mod Sec 165th Infantry
 Det Serv Co 165th Infantry
 1st Plat Cn Co 165th Infantry
 1st Plat AT Co 165th Infantry
 1st Plat Co D 766th Tk Bn (L)
 1st Plat Co C 102nd Engr Bn (C)
 1st Plat Co B 102nd Med Bn (Coll)
 Btry A 105th FA Bn
 Co B 152nd Engr Bn (C) (Shore Party)
 Det 27th Div MP Plat
 Bn JASCO Team

3. COMPOSITION OF BLT 165-2

2nd Bn 165th Infantry
 2nd Bn Mod Sec 165th Infantry
 Det Serv Co 165th Infantry
 3rd Plat Cn Co 165th Infantry

3. COMPOSITION OF BLT 165-2 (CONT'D)

2nd Plat AT Co 165th Infantry
 2nd Plat Co D 766th Tk Bn (L)
 2nd Plat Co C 102nd Engr Bn (C)
 2nd Plat Co B 102nd Med Bn (Coll)
 Btry B 105th FA Bn
 Co C 152nd Engr Bn (C) (Shore Party)
 Det 27th Div MP Plat
 Bn JASCO Team

4. COMPOSITION OF BLT 165-3

3rd Bn 165th Infantry
 3rd Bn Med Soc 165th Infantry
 Det Serv Co 165th Infantry
 3rd Plat AT Co 165th Infantry
 3rd Plat Co D 766th Tk Bn (L)
 3rd Plat Co C 102nd Engr Bn (C)
 3rd Plat Co B 102nd Med Bn (Coll)
 Btry C 105th FA Bn
 Co A 152nd Bn (C) (Shore Party)
 Det 27th Div MP Plat
 Bn JASCO Team

KELLEY
 CMDG

OFFICIAL :

Scates
 /COATES
 S-3

ANNEX ABLE

39

RCT 165
APO # 27
26 May 1944

ANNEX "BAKER" to accompany FO # 10

INTELLIGENCE

MAPS: Special Terrain Maps; Scale: 1/20,000, I of SAIPAN, I of TINIAN and I of GUAM.

1. SUMMARY OF ENEMY SITUATION:

a. General: The Japanese occupy the following bases, SAIPAN, TINIAN and GUAM. All of these bases have landing fields, sea-plane bases, or both. There has been a steady increase of enemy strength in the MARIANAS and Western CAROLINES in apparent anticipation of our attack.

b. Estimated Strength as of 9 May 1944:

- (1) SAIPAN: 9,000-10,000
- TINIAN: 7,500- 8,500

(a) Composition: No breakdown between islands is available but estimates give the composition of combined forces as:

- Army Troops: 4,000 - 5,000
- Navy Combat Troops: 8,500 - 9,000
- Construction: 4,000 - 4,500 (Koreans may make up part of this group.)

(b) Air: Combined air strength on SAIPAN and TINIAN is estimated as over 250 planes. Fighters appear stronger on SAIPAN than TINIAN with bombers based on TINIAN.

- (2) GUAM: 6,000 - 8,000.

(a) Composition:

- Army Troops: 4,000 - 5,000
- Navy Combat Troops: 1,000 - 1,500
- Construction: 1,000 - 1,500 (Koreans may make up part of this group.)

(b) Air: Planes based at GUAM are estimated at approximately 100 divided fairly evenly between fighters and bombers.

- (3) It may be expected that the enemy will employ the following types of planes:

Fighters

"ZEKE"	"TONY"
"HAMP"	"OSCAR"
"TOJO"	"JAKE" (pontoons)
"NICK"	"RUFÉ" (pontoons)

Two Engine Bombers

"BETTY"	"SALLY"
"HELL"	"DORIS"
"LILY"	"HELEN"

Single Engine Bombers

"JUDY" "KATE" "VAL"

Four Engine Flying Boats

"EMILY" "NAVIS"

Four Engine Bomber

"LIZ"

Trainer

"TESS"

c. Enemy Dispositions from photo interpretations of sortie 18 April 1944: Situation Maps of 5th Amphibious Force and V Phib Corp have been issued to BLT's.

d. G-2 Study, HQ 27th Inf Div, of SAIPAN, TINIAN and GUAM as issued to each BLT.

2. ENEMY CAPABILITIES:

a. SAIPAN:

- (1) The enemy is capable of defending at the beaches using all of his forces estimated to be on the island.
- (2) The enemy is capable of opposing our landings at the beach and then withdrawing to previously prepared but unlocated positions on the high ground in rear of the beach.
- (3) The enemy is capable of withdrawing from the beaches to permit our unopposed landing and counterattacking with all its forces to include tanks and mechanized vehicles.
- (4) The enemy is capable of reinforcing its present garrison at any time, by sea or air, with forces of undetermined strength from other bases.

b. TINIAN and GUAM: When issued will become Appendix to this Annex.

3. ESSENTIAL ELEMENTS OF ENEMY INFORMATION - SAIPAN:

a. To accompany Opns Plan I:

- (1) Are there any underwater or beach obstacles (man made or natural) in front of or on PURPLE BEACH # 1?
- (2) Will the enemy oppose our landings at the beach? If so with what strength?
- (3) Will the enemy give light resistance at the beach but defend in force on the high ground in rear of the beaches?
- (4) Will the enemy move reserves from South? From North of CHATCHA VILLAGE? From the West utilizing the saddle and road CHATCHA VILLAGE - FLORES POINT to defend the beaches when the threat at MAGICIENNE BAY develops?

(5) Will the enemy counterattack using its reserves and mechanized units? - if so when, where and what type?

(6) Is the terrain, roads, trails in rear of and North and South of BEACH PURPLE # 1 passable to track laying vehicles?

(7) Will the enemy hold each position until annihilated?

b. To accompany Opns Plan II:

(1) What is the enemy situation confronting the 2nd and 4th Marine Div's?

(2) Where are the enemy reserves located?

c. To accompany Opns Plan III:

(1) Does the enemy occupy MANIAGASSA ISLAND and if so in what strength and what are types of defense?

(2) Are there any underwater or beach obstacles (man made or natural) on or in front of SCARLET BEACH # 1?

(3) Will the enemy oppose our landings at the beach? If so in what strength?

(4) Has the enemy prepared defensive positions, particularly tank obstacles, inland from SCARLET BEACH # 1 and the area along the road FLORES POINT - CHATCHA VILLAGE?

(5) Will the enemy counterattack using his reserves and mechanized units? If so will the attack come from the Northwest? - East? - or North of GARAPAN TOWN?

(6) Will the enemy hold each position until annihilated?

NOTE: EEI for TINIAN and GUAM, when issued, will become Appendices to this Annex.

NOTE: EEI to accompany other Opns Plans will become Appendices, when issued, to this Annex.

4. RECONNAISSANCE AND OBSERVATION MISSIONS - SAIPAN - PLAN I :

a. Air

(1) Request observation of PURPLE BEACH # 1 during the day and prior to NAN HOUR for the location and extent of the following

a. Underwater obstacles (man made or natural), barbed wire and gun emplacements.

b. Any movement of enemy troops or mechanized units on the roads running North and South from HARPI POINT to ASLITO AIRFIELD.

c. Continual observation during the landings on PURPLE BEACH # 1 inland to CHATCHA VILLAGE - HILL 768 for location and movement of troops and mechanized force location of entrenchments, artillery and mortar positions, Report to RCT CP afloat or ashore as observed.

b. Assault Units:

(1) Observe for and report:

a. Any underwater or beach obstacles.

b. Tank ditches and barriers.

c. Mine fields.

d. Any changes in known installations on beach.

e. Type and weight of fire received by boats before landing.

f. Strength of forces encountered on beach.

g. Any withdrawal of enemy forces from the beach to high ground in rear of beach.

c. Artillery:

(1) Forward Observers report information as directed above.

(2) FO's report any arty positions in rear of enemy front lines.

(3) FO's report any mortar, machine gun positions, movement of troops and mechanized forces.

(4) All reports as observed.

d. Intelligence and Reconnaissance Platoon:

(1) Be prepared to reconnoiter SW of PURPLE BEACH # 1 for movement of enemy troops or mechanized forces.

(2) Be prepared to reconnoiter the high ground inland from the beach for enemy positions and to ascertain whether the terrain can be traversed by tanks.

(3) Be prepared to establish OP on high ground inland from the beach.

e. Co C 102nd Engr Bn (C):

(1) Observe for and report beach and hydrographic conditions in accordance with SOP for such reconnaissance.

(2) Report information as observed.

(A)4. RECONNAISSANCE AND OBSERVATIONS MISSIONS - SAIPAN - PLAN II

a. To be issued, if, and when, situation permits.

(B)4 RECONNAISSANCE AND OBSERVATION MISSIONS -SAIPAN - PLAN III :

a. Air:

(1) Request observation of SCARLET BEACH # 1 during the day and prior to NAN Hour for the location and extent of the following:

- a. Evidence of any troops or installations remaining on MANIAGASSA ISLAND.
- b. Any underwater or beach obstacles.
- c. Tank ditches and obstacles.
- d. Mines and barbed wire in the water and on the beach.
- e. Coral heads or rocky areas on beach which will prevent landings.

(2) Request continued observation for movements of enemy troops or mechanized units on the road running North and South from MARPI POINT to GARAPAN TOWN and the roads running East and West through the mountain range. Report by radio to RCT CP as observed.

(3) Request continued observation during the landing on SCARLET BEACH # 1 as far inland as the summit of the mountain range and South to GARAPAN TOWN for movement and location of troops and mechanized forces, location of strongpoints, artillery and mortar positions and tank obstacles. Report to RCT CP afloat or ashore as observed.

- b. Assault Units:
- (1) Observe for and report:
 - a. Any underwater and beach obstacles.
 - b. Tank ditches and barriers.
 - c. Mine fields.
 - d. Any changes in known installations on the beach.
 - e. Type and weight of fire received by boats before landing.
 - f. Strength of forces encountered on the beach.
 - g. Any withdrawal of enemy forces from the beach to high ground in rear of beach.
 - h. The type and caliber of fire received from MANIAGASSA ISLAND.
- c. Artillery:
- (1) Forward Observers report information as directed above.
 - (2) FO's report any arty positions in rear of enemy front line.
 - (3) FO's report any mortar or machine gun positions and movement of troops and/or mechanized units.
 - (4) All reports as observed.
- d. Intelligence and Reconnaissance Platoon:
- (1) Be prepared to reconnoiter to the Northeast along the road MARPI POINT - GARAPAN TOWN for movement of enemy troops and/or mechanized forces.
 - (2) Be prepared to reconnoiter to the East along the roads running East and West through KARABERRA PASS for the movement of enemy forces and/or mechanized units.
- e. Co C 102nd Engr Bn (C)
- (1) Observe for and report beach and hydrographic conditions in accordance with SOP for such reconnaissance.
 - (2) Report information as observed.
- NOTE: Missions for TINIAN and GUAM, when issued, will become Addenda to this Annex.

5. MEASURES FOR HANDLING PRISONERS AND CAPTURED DOCUMENTS:

a. Prisoners of War:

(1) Prisoners can and must be taken and every effort will be made to capture them. Troops will be encouraged to make maximum use of Jap Combat Phrases which have been issued.

(2) Initial Collecting Points: MP's assigned to each of the assault Bn's will establish a collecting point under the direction of the Bn S-2, in the vicinity of the beach upon which the Bn lands. Four (4) of the attached MP's should be landed for this purpose with the reserve company. POW's captured in the initial stages of the assault will be sent under guard to the Initial Collecting Point where they will be taken over by the MP's and guards released to their unit.

(3) Upon establishment of the Regtl CP, a similar POW cage will be established sufficiently in from the beach so as not to interfere with traffic, and a short distance from the Regtl CP. Bn S-2's will limit their interrogation to matters of immediate

importance only and will expedite movement of POW to the rear.

(4) POW's will not be evacuated to ships without the authority of G-2.

(5) POW's will be tagged at the Bn interrogation point with POW tags provided to S-2's and MP's. All tags will be properly filled out giving all pertinent information.

(6) All written material, dog tags, maps, diaries, and other items of intelligence value, taken from prisoners when searched, will be sent to the rear with prisoners in care of the guard. Material of immediate tactical value to the capturing unit may be retained but report of contents will be made to this Hq.

(7) Bn S-2 will take advantage of all returning troops and transportation to send POW's to the rear.

(8) Wounded prisoners will be given medical treatment. The Medical Officer will determine the amount of questioning. Every opportunity will be taken to question prisoners immediately after medical treatment, as experience has shown that it is at this time that prisoners talk most freely.

(9) It can be expected that Japanese and Korean civilians in large numbers will be encountered. These persons will be taken into custody and processed as POW's, but then will be kept separate from military and naval POW's at all times. They will not be tagged.

(10) Chamorros and Kanaka natives will be treated as POW's until their loyalty has been established. They will be kept separate from Japanese or Korean service and civilian POW's. Every consideration will be afforded the natives.

b. Interpreters

(1) One (1) interpreter will be assigned to each assault BIT. Upon establishment of the Regtl CP ashore these two (2) interpreters will revert to Regtl control. A capable enlisted man will be in constant attendance with each interpreter and will be responsible for his safety.

(2) Full use will be made of the personnel who have attended the Division Language Schools.

c. Documents and Captured Materiel:

(1) All written or printed papers, maps, documents, books, and diaries, regardless of where found, will be collected by units and processed through Bn S-2. Plates attached to enemy materiel will not be removed.

(2) Particular attention is directed to Japanese Codes, Ciphers and similar documents, which are usually bound in red or pink covers or in covers with red or pink borders. These, as with maps and orders, will be given immediate priority and returned through channels by most expeditious means available.

(3) Captured materiel will be utilized at the front line until no longer of value, after which it will be removed to the rear to the salvage dump as prescribed in Adm O # 1.

(4) Enemy CP's, OP's, Hq's, etc., will be placed under guard immediately upon seizure, and only officers and authorized intelligence personnel will be permitted entrance thereto.

(5) An intelligence team from the Joint Intelligence Center, if and when attached to the Division, will accept custody of all documents and written or printed matter.

(6) All personnel who are authorized to search enemy CP's, OP's, etc., and to take over same from guards of assault troops will carry a pass signed by an officer from Div G-2, Regtl S-2, or Bn S-2. These passes will be issued to each Bn S-2.

d. Souvenirs:

(1) Souvenir collecting has caused loss of life to allied troops during other engagements. A souvenir kept by a soldier may be the key to make a decision which will save many lives. No material of any type will be retained as a souvenir until it bears a stamp-mark identifying it as valueless as intelligence matter. Personnel forwarding captured material for intelligence inspection may write their name, rank and organization on the material as effort will be made to return such if it is found to be valueless.

(2) Reports from other combat zones emphasize the complete disregard by troops for property. Enemy food, equipment and supplies have been destroyed for no reason. Even our own supplies and equipment have received the same treatment from our troops. All men will be warned against this practice. Not only may such supplies and equipment be needed urgently, but many types of Jap equipment are in demand by the War Department for research purposes. By destruction of any kinds of property, a soldier is aiding the enemy.

e. Broadcasts to Japanese to surrender:

(1) There will be available at Division Headquarters loud speakers and interpreters prepared to broadcast to the Japs to surrender. Experience has proven this method to be successful in taking prisoners from isolated units or when the enemy realizes that defeat is obvious.

(2) When circumstances arise which make it appear that such a broadcast may produce desired results, requests for this equipment will be submitted to Division G-2 through this Hq. These requests will state the circumstances and the time and place at which the system is desired. Consideration must be given to the time necessary in which to brief the interpreter and send him to the location picked for the broadcast.

6. MAPS AND PHOTOGRAPHS:

a. Maps of SAIPAN, TINIAN, GUAM, scale 1/20,000, overprinted with photo interpretation, target squares and beaches.

Distribution: To squads and similar units.

b. Maps of SAIPAN, TINIAN, GUAM, scale 1/62,500.

Distribution: To platoons and similar units.

c. Photo maps of SAIPAN, TINIAN, GUAM, scale 1/20,000, lithographed mosaic.

Distribution: One (1) per company with special distribution to Artillery.

d. Stereo pairs.

Distribution: As received.

e. Oblique photos.

Distribution: As received.

f. Detailed distribution in accordance with the directions accompanying delivery of maps.

7. COUNTER-INTELLIGENCE.

a. Individual Instructions

(1) Operation orders, overlays, marked maps, SOP's, SOI's, and other compromising material will not be taken forward of Regimental CP's. Extracts from orders and SOI's considered essential may be taken as far forward as Battalion CP's. Officers will destroy completely any compromising material if capture appears imminent.

(2) Personnel are prohibited from having diaries in their possession, or other documents or material which would reveal any information of value to the enemy. Unit commanders are responsible for the enforcement of this restriction.

(3) Officer's insignia will be worn but not exposed.

(4) All personnel will be warned again to give only their NAME, RANK and SERIAL NUMBER in case of capture. Increasing efforts on the part of Japs to take prisoners, as shown in captured documents, reveal that the enemy has obtained valuable information from prisoners who have talked.

(5) When vacating an area, "security" policing will be strictly observed to insure that no compromising papers may be found by infiltrating Jap patrols.

(6) Camouflage discipline will be maintained habitually.

(7) Signal Security: Officers and enlisted men will guard against revealing information which can be used by the enemy when they speak over voice radio or telephone. The same applies in authorizing messages to be sent in the clear by key transmission.

(8) Countersigns: Annex HOW.

(9) Censorship: As prescribed by Section XIV, Alert Restrictions, "Guide To Unit Censors", APO 27, subject to special restrictions.

(10) Press Relations: Correspondents and photographers are assigned to this force for complete news coverage of the Operation. Every consideration will be given their assignment and need for knowledge of events. Correspondents will be given a clear picture of proposed operations in order that their coverage may be

complete and accurate. All personnel will give true, uncolored facts when interviewed.

8. REPORTS AND DISTRIBUTIONS:

- a. Bn S-2's will submit S-2 Periodic Report as of 1600 each day to Regtl CP by most expeditious means available.
- b. Routine report from front line units to Bn S-2.
- c. Flash reports immediately to Regtl CP concerning para-troops, enemy aviation, tanks and mechanized vehicles.

KELLEY
Cmdg

OFFICIAL:

McCaill

McCAHILL
S-2

(Classification will be removed upon entering the combat area.)

S E C R E T

S E C R E T
AUTH: CG 27 Div
INITIALS: V.A.
DATE: 10 May 1944

APPENDIX #1 to ANNEX BAKER

G-2 STUDY - SAIPAN, TINIAN.

STRATEGICAL IMPORTANCE	SECTION I
SAIPAN	SECTION II
TINIAN	SECTION III

SECTION I

1. STRATEGICAL IMPORTANCE.

The sister islands of SAIPAN and TINIAN are located approximately 100 miles northeast of GUAM. They have been referred to as "anchored aircraft carriers", for their principle tactical value at present lies in their use as air bases. Naval anchorages are limited unless man made.

By capture of the islands, the United Nations will cause a break in JAPAN's communication system to her outer islands. She will lose a spring board for her heavy bombers and a stepping stone for her fighters on their way to TRUK, PONAPE, KUSAIE, PALAU, and the PHILIPPINES.

With SAIPAN and TINIAN in Allied hands, our long range bombers can reach any center in JAPAN, 1300 miles away.

S E C R E T

APPENDIX #1 to ANNEX BAKER

S E C R E T

S E C R E T

S E C R E T

SECTION II

SAIPAN

1. GENERAL.

SAIPAN is a mountainous island located approximately 100 miles northeast of GUAM. Its northeast - southwest length is approximately 13 miles. Its east - west width averages $2\frac{1}{2}$ miles, but two peninsulas jutting to the east extend this width to as great as $5\frac{1}{2}$ miles at these two points. The island contains about 72 square miles.

2. GEOGRAPHICAL FEATURES.

a. Mountain Range. A mountain ridge extends from the north of the island for somewhat over 10 miles when it levels off into foot hills averaging 200 feet in height which form the southern and most level part of the island. MT. MARPI, (833 feet), is the northern most point of the range and rises with steep cliffs on the west and north from a level coastal plain about 1500 yards wide at the north end of the island. About 8000 yards southwest of MT. MARPI, the second highest elevation on the island occurs, an unnamed peak of 1050 feet. Between the two peaks lesser peaks rise with resulting saddles between them. An improved road and another partially improved road cross one of these saddles 2500 yards southwest of MT. MARPI. The other passage crossing this area of the range is KALAPERAS PASS, in a saddle just north of the unnamed 1050 foot peak.

The remaining length of the range consists of a 5500 yard saddle, the southern end of which rises to MT. TAPOTCHAU, the highest elevation on the island, (1554 feet). An improved road running southeast from FLORES POINT, crosses the center of the saddle. From MT. TAPOTCHAU the elevation drops to 789 feet in 3500 yards and thence abruptly to the foothill plain which forms the southern quarter of the island.

Except for the roads mentioned, the range presents an obstacle for motor traffic between the coastal plain which forms the western side of the island and the rolling country on the eastern side. It is not improbable that trails cross the range in addition to the roads mentioned.

S E C R E T

APPENDIX #1 to ANNEX BAKER

S E C R E T

S E C R E T

S E C R E T

b. Shoreline. Except for a portion of MAGICIENNE BAY, the south, east, and north shorelines present cliffs and steep rises from the ocean. The western shore provides sand beaches for most of its length and a gradual rise from the water but is guarded for its entire length by a barrier reef which merges into a fringing reef on the north. The reef shows but a few narrow breaks.

c. Shore to Ridge. A relatively level coastal plain on the west side of the island runs inland to the ridge for distances of 800 to 1500 yards. Level areas also appear in the north but as terraced plateaus with sheer drops between plateaus. On the east side level areas are limited. The south end of the island presents the largest level area, for as noted, in this area the mountain ridge slopes off into rolling country.

3. VEGETATION.

The ridge area is heavily wooded with some open but brush covered areas present. This brush can prove a serious obstacle to movement. The remainder of the island is cultivated, primarily with sugar cane.

4. CLIMATOLOGY.

a. Rain. The dry season occurs from December to June with heavy rains prevalent from July thru November. Average rainfall in the wet season is 12 inches per month with rain occurring at sometime almost every day.

b. Winds. From November to April prevailing surface winds are from the northeast. From May to October winds from the east are generally the rule with winds from the south and west not uncommon.

c. Temperature. Summer temperatures average 79° F with average ranges between 74° and 84° F.

5. LANDINGS.

a. The cliffs along the north, east, and south shores limit landing beaches to small, separate areas, with exception of MAGICIENNE BAY.

b. The low slopes on the western side of the island afford frequent beaches except in the northern part. However, except for the most northern part, the shoreline is protected by almost continuous barrier or fringing reefs. Passages thru the reefs lead generally into a shallow lagoon. For the most part natural obstacles are not present at the shoreline.

S E C R E T

APPENDIX #1 to ANNEX BAKER

S E C R E T

S E C R E T

S E C R E T

6. ANCHORAGES.

a. GARAPAN Anchorage lies about $1\frac{1}{2}$ miles west of GARAPAN Town but outside the reef. It is untenable in southerly or westerly weather.

b. TANAPAG Harbor, north of GARAPAN Town, is almost completely enclosed by a barrier reef. It is entered thru a narrow, blasted channel. Last known information states that coral heads were present and depths were such as to make the harbor limited to small and medium draft ships. It is known that extensive harbor improvements were planned by the Japanese in 1939 but how much improvement has taken place cannot be said.

c. MAGICIENNE BAY is not much more than an open roadstead affording shelter against winds from the south and west. Large vessels can anchor within 800 yards of the beach.

7. WHARVES. A 2000 foot wharf is found in TANAPAG HARBOR with piers at GARAPAN. One 450 foot pier is present at CHARAN-KANOA. All piers are of modern construction.

8. COMMUNICATIONS.

a. Roads. The highway net work of SAIPAN consists of over 60 miles of graded roads of 15 - 20 foot width and serving all parts of the island. Except for unusual conditions main roads should carry T/E vehicles. A road generally circles the island except for a space along the northern part of the eastern shore and the eastern half of the southern shore. The southern third of the island contains a good road net. The northern third of the island is crossed by three roads, the most northern one partially of secondary nature. The central third is void of cross island roads. A network of cane roads similar to those in the HAWAIIAN ISLANDS can be expected in all cane areas.

b. Railroad. The railroad exists primarily for sugar reasons. It appears to run entirely around the island except for the central third of the eastern side. Branch lines run off the main line at various points. 25 sidings appear in the town of CHARAN-KANOA.

c. Telephone lines apparently connect centers of activity on the island.

9. AIR INSTALLATIONS.

a. Seaplane. A base with two concrete ramps fronts on TANAPAG HARBOR at FLORES POINT, about 3 miles northeast of GARAPAN.

S E C R E T

APPENDIX #1 to ANNEX BAKER

S E C R E T

S E C R E T

S E C R E T

b. Airfields.

- (1) A 3600' X 900' runway known as ASLITO Airfield is located centrally in the southern part of SAIPAN. It runs east - west. A second runway extending southwest from the main runway is under construction.
- (2) A second airfield (NW - SE runway) is located north of CHARAN-KANOA.
- (3) A third field (E - W runway) has recently been completed at the north end of the island.

10. POPULATION.

As of last available reports (1938), the Japanese civilian population was approximately 25,000 plus a native population of about 3,200, 3/4 Chamorros and 1/4 Kanakas. Population is generally centered in the towns of GARAPAN (10,000), CHARAN-KANOA (2-3,000), and six villages of 200-800 inhabitants. A tenant farming system tends to scatter the remainder. Most of the natives lived in GARAPAN.

11. FOOD and WATER.

a. Food production in SAIPAN is sufficient only for the needs of the population. Tapioca is grown for export and potatoes and taro for home consumption. Rice must be imported. Cocoanuts, breadfruit, pineapples, and bananas are limited. Fish is always available. Hogs, goats, and wild deer were present.

b. Water is a serious problem as it is derived almost entirely from rain water. Each house has its own collecting tank and the railroad has erected some tanks (averaging 22,000 gallons each) along its lines.

12. HEALTH and SANITATION.

a. Diseases. Prevailing diseases are dysentery, typhoid, paratyphoid, dengue fever, and eye trouble. Cases of malaria are rare. Occasional cases of venereal diseases are reported, doubtless increased at this time, and six cases of leprosy were known in 1936.

b. Sanitation conditions are only fair. There is no sewerage system. Garbage and refuse collection has been inadequate. Pigs are kept in every native house. Flies are very numerous as a certain type was introduced some years ago to combat a sugar blight with the result that all flies have gained an immunity status. Mosquitoes are numerous, tho none are of the Anopheles type.

S E C R E T

APPENDIX #1 to ANNEX BAKER

S E C R E T

S E C R E T

S E C R E T

13. NATIVES.

a. CHAMORROS are of the earliest races of the Pacific. Today they are a blend of Chamorro, Tagalog from the Phillipines, and Spanish. Their color is light and their language, like their clothing, shows the Spanish influence. The hospitality of a Chamorro is reminiscent of Spain.

b. KANAKAS make up 1/4 of the native population. They are a brown skinned people more in keeping with what one would expect of a Pacific island. Their homes are usually thatched and their clothing scanty.

c. Both races are being squeezed out by the Japanese. While it might appear that the natives would welcome a generous, friendly people and doubtless will, it must be considered that change of rule from Spanish to German to Japanese with their frequent unpleasant incidents cannot have helped but put the native in a "what next" frame of mind.

S E C R E T

APPENDIX #1 to ANNEX BAKER

S E C R E T

S E C R E T

S E C R E T

SECTION III

TINIAN

1. GENERAL.

The island of TINIAN lies approximately 3 miles southwest of SAIPAN. It is about 10 $\frac{1}{2}$ miles long in a north-south direction and its maximum width is 5 miles in an east-west direction. Total area of the island is approximately 48 square miles.

2. GEOGRAPHICAL FEATURES.

a. Shoreline. Except for a sand beach protected by a fringing reef in the southwest portion of the island, the balance of the shore line consists of steep cliffs of varying heights which generally drop directly to the water.

b. Inland Terrain. A mountain range covers the northern end of the island and follows the east coast to the southern tip. LASSO HILL, about 4 $\frac{1}{3}$ miles south of USHI POINT, the north end of the island, is the highest elevation (564 feet). 2000 yards northwest of LASSO HILL is another high point (456 feet). The range shows a rise about half way down the east side but the only other elevation of significance is 531 feet at LALU POINT at the very south.

The major balance of the island is a basaltic plateau with many different levels similar to terraces with sharp drops from one to another. Broadest terraces are in the central part west of the range.

c. Soil Texture. Most of TINIAN is coral limestone with rock out croppings. The soil is dry and somewhat sandy and thereby less disposed to rank and overluxuriant vegetation.

3. VEGETATION. TINIAN is a sugar island with the majority of its tillable area devoted to growing sugar cane.

4. CLIMATOLOGY. Similar to SAIPAN.

5. LANDINGS.

a. The cliff-like structure of the island makes beaches most limited. The only landing of size is at TINIAN Town and even here the

S E C R E T

APPENDIX #1 to ANNEX BAKER

S E C R E T

S E C R E T

S E C R E T

beach is fronted by a shelving reef terminating in a barrier reef. Entrance to the shallow TINIAN Harbor is accomplished thru a narrow channel thru the reef opposite the south end of the town.

b. There is a 150 yard beach on the east coast about 7500 yards south of USHI POINT and a 275 yard beach on the west coast about 5000 yards southwest of the point. Both are protected by coral shelves.

6. ANCHORAGES.

Ships usually anchor off the barrier reef protecting TINIAN Harbor but the anchorage is poor and in bad weather it is reported that ships must seek protection at SAIPAN.

7. WHARVES.

A small concrete pier crosses the fringing reef in front of TINIAN Town. Another pier to the south and opposite a warehouse is equipped with sidings and a travelling crane.

8. COMMUNICATIONS.

a. Roads. A road circles the island but in from the sea and extends to the north and south ends by branches from the circle.

b. Railroad. A narrow gauge railroad follows the general circle of the road with branches covering the cane area in the south. The terminus with its yards is located in TINIAN Town where the quarter mile long, cement walled refinery is situated.

c. Telephone and radio. Telephone lines probably follow the main lines of the railroad. Four (4) radio stations are reported serving the island.

9. AIR INSTALLATIONS .

a. The USHI POINT airfield at the north end of TINIAN is the principle field and is built to accomodate fighters and bombers. It is hard surfaced and surrounded by a large, well developed area containing taxiways, dispersal areas and revetments, hangars and shops.

b. A second field is under construction half way up the island on the west side.

c. No seaplane bases are present.

S E C R E T

APPENDIX #1 to ANNEX BAKER

S E C R E T

S E C R E T

S E C R E T

10. POPULATION.

a. Reports of 1936 show somewhat over 15,000 civilians living on TINIAN. Of these the majority are Japanese with colonists from the LOOCHOOS in predominance. There is little doubt that this number has since increased.

b. Native population is probably very limited. When TINIAN was occupied by the Spanish, all natives were deported and few have returned in spite of many elapsing years. Those who may be living on the island will be similar to the natives of SAIPAN.

11. FOOD and WATER.

a. Food conditions are similar to SAIPAN but the fertility of the soil and its varying plateau elevations has given the island a reputation for its "super" products.

b. The water situation is comparable with SAIPAN, dependent on rainfall collected in cisterns.

12. HEALTH and SANITATION. See Section II, SAIPAN.

13. NATIVES. See Section II, SAIPAN.

W. M. Van Antwerp

WM. M. VAN ANTWERP
Lt Colonel, GSC
AC of S, G-2.

2 Incls:

- #1 - Sketch of SAIPAN
- #2 - Sketch of TINIAN.

S E C R E T

APPENDIX #1 to ANNEX BAKER

S E C R E T

SECRET

SECRET

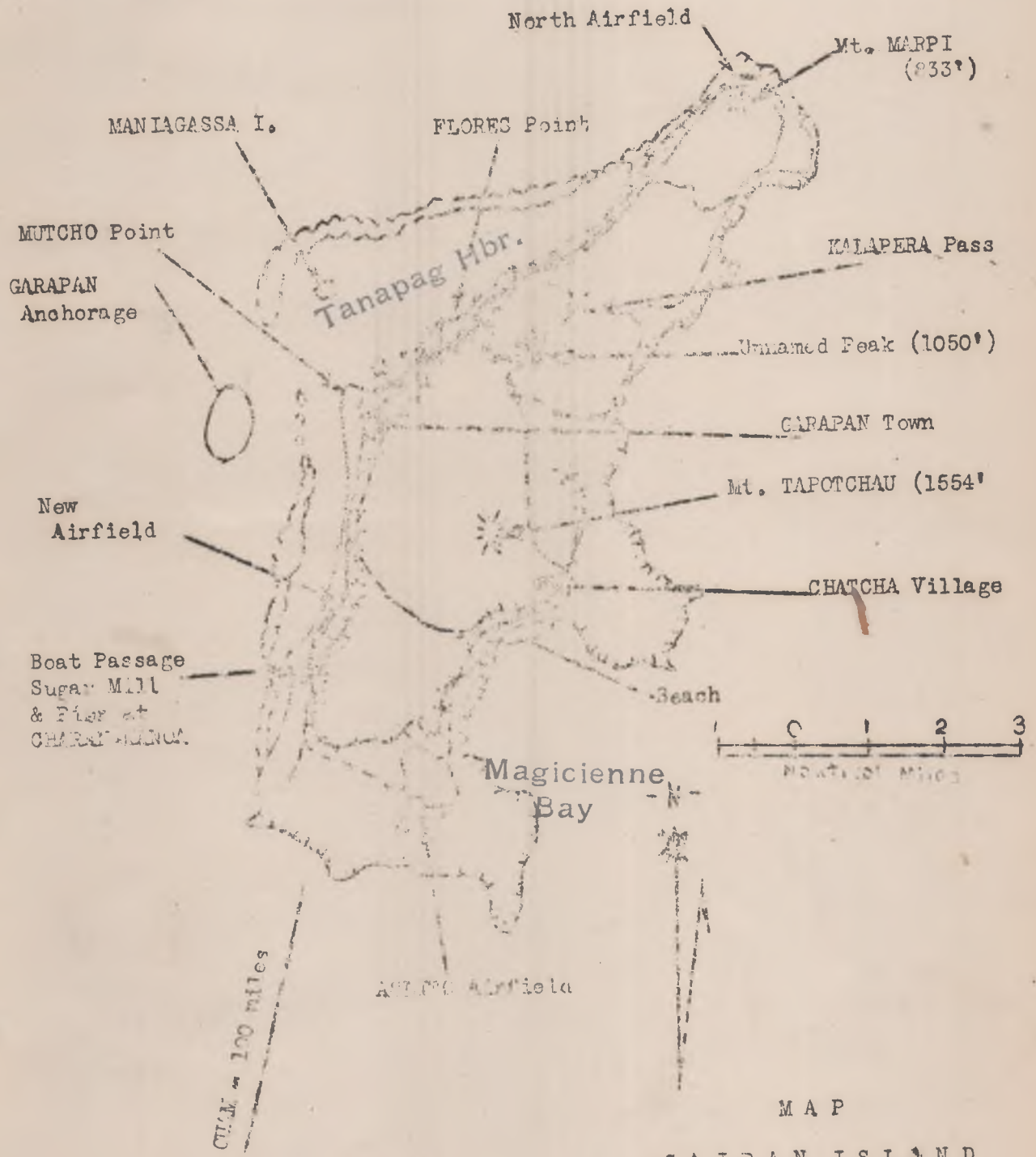

New Airfield

Boat Passage
Sugar Mill
& Pier at
CHARAPANGUA

100 miles



MAP

SAIPAN ISLAND

SECRET

Inlosure No. 1
APPENDIX #1 to ANNEX BAKER

SECRET

S E C R E T

S E C R E T

MAP of
T I N I A N I S L A N D

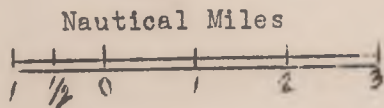
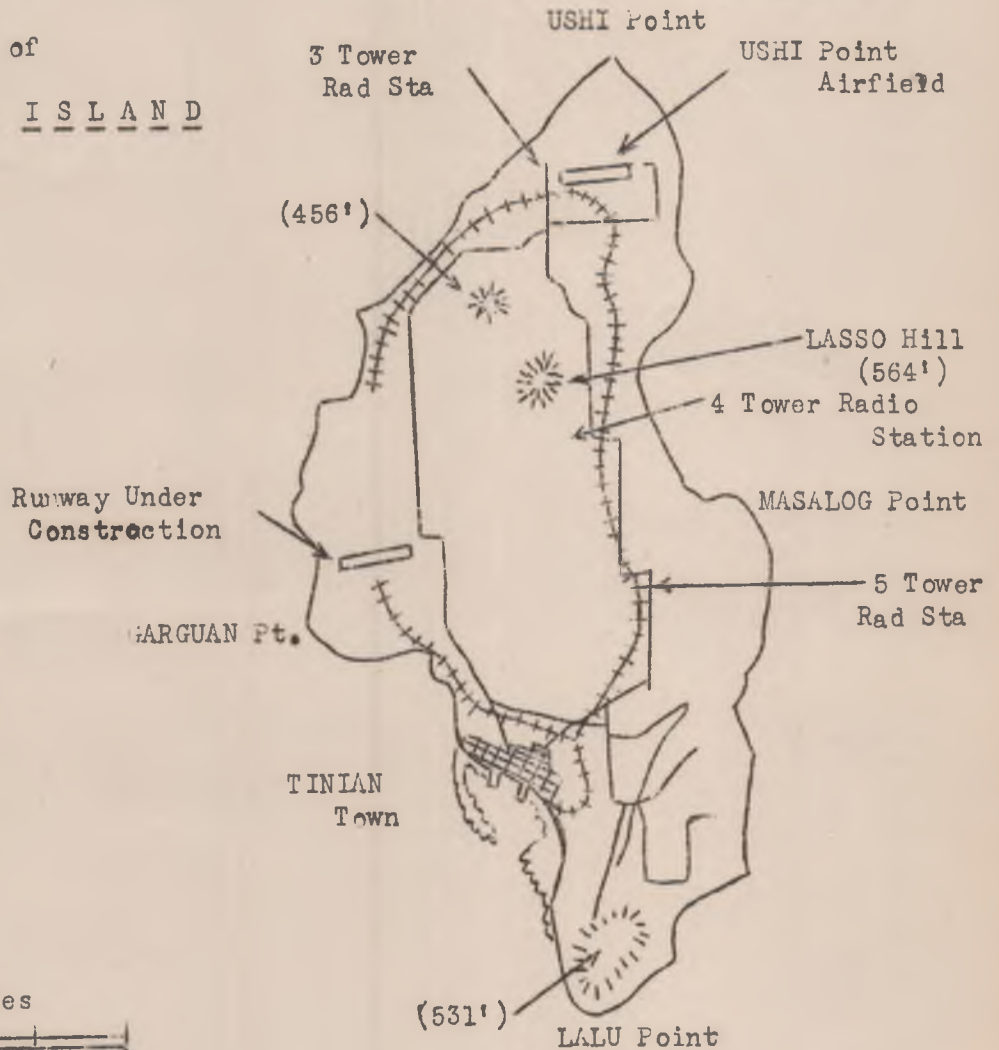

Inclosure #2

S E C R E T

APPENDIX #1 to ANNEX BAKER

S E C R E T

AUTH: CG 27TH INF DIV

INITIALS: VA

DATE: 28 May 1944

RCT 165

APO # 27

28 May 1944

ADDENDA I to ANNEX "BAKER"
(For Opns Plans IV and V, Black Beaches)

2. ENEMY CAPABILITIES.

a. SAIPAN:

(1) The enemy is capable of defending at the beaches with all forces not engaged with the 2nd and 4th Marine Divisions.

(2) The enemy is capable of permitting our unopposed or lightly opposed landing and fall back on prepared but unlocated positions along the high ground S of MAKUNSHA - KARABERRA PASS Road - MATOISA - ridge extending W from MATOISA.

(3) The enemy is capable of withdrawing to the N or S to successive defensive positions.

(4) The enemy is capable of reinforcing by moving troops to Beach BLACK from any point on the island in 1/2 hour by motor; in 2-1/2 hours by marching and using these troops for counter attacks.

Discussion: Based upon P.I. Reports of 6 May 1944, it is estimated that the area between TANAPAG and MT. MARPI and W of the range is defended by one (1) battalion plus artillery, DP, and CD gun crews. Additional reinforcements arriving on SAIPAN after 6 May 1944 may be committed to the defense of this sector.

Roads leading into the sector afford no concealment for movement of troops and movement of enemy reserves by roads should afford remunerative targets to air and naval gunfire.

Comparatively few installations appear at Beaches BLACK. However, heavy installations are present along both slopes of the range and it is probable that there are additional installations dug into the range which do not appear in photos. Such being the case the enemy could occupy the range positions prior to a landing and could (1) counter attack toward the beaches from them or (2) use them as a main defensive line to which any beach defense forces can withdraw.

Positions along the range have clear observation of all Beaches BLACK and from them the entire beach area can be subjected to observed fires.

Attention is called to the following terrain features: (1) ATCHUGAU and the range running N therefrom from which observation of Beaches BLACK is possible.

(2) The deep ravine running N to the sea from ATCHUGAU.

(3) Nose of ridge which divides Beaches BLACK and presents an estimated 40 ft. cliff which rises from the road.

(4) Steep cliff averaging 20 ft. directly in rear of Beach BLACK # 1 and the northern part of Beach BLACK #2 and between the beaches and the road.

3. ESSENTIAL ELEMENTS OF ENEMY INFORMATION:

a. To accompany Opns Plans IV and V, Black Beaches.

- (1) Are there any obstacles (man made or natural) along the fringing reef and beaches?
- (2) Will the enemy defend in force at the beaches?
- (3) Will the enemy give light resistance at the beaches and withdraw to the high ground inland from the beaches?
- (4) Will the enemy move reserves from the north, south, and/or east when the threat at Black Beaches develops?
- (5) What defensive positions has the enemy prepared along the range E of Black Beaches in addition to those located in P.I. reports?
- (6) Will the enemy employ tanks? If so, where, when, what type?
- (7) Is the terrain inland from Black Beaches thru the range and off the roads passable to track laying vehicles?

KELLEY
Cmdg

OFFICIAL:

*McCaill*McCAHILL
S-2

AUTH: CG 27th Inf Div
INITIALS:
DATE: 26 May 1944

RCT 165
APO # 27
28 May 1944

APPENDIX III (a) TO ANNEX "BAKER"

2. ENEMY CAPABILITIES: TINIANa. WHITE BEACHES.

- (1) The enemy is capable of defending in force at the beaches.
- (2) The enemy is capable of defending at the beaches and withdrawing to a main defensive line of prepared positions on the ridge SW of the north airfield and in the building areas SW and NW of the airfield from which positions he can also launch counter attacks at any time after a landing.
- (3) The enemy is capable of moving reserves S from USHI POINT to reenforce beach defenses or to counter attack. This can be accomplished in 30 minutes by marching.
- (4) The enemy is capable of moving reserves N from TINIAN TOWN to reenforce his northern defense system or to counter attack. This can be accomplished in 30 minutes by motor or 1-1/2 hours by marching.
- (5) The enemy is capable of opposing a landing with artillery or DP fire from the ridge SE of the beaches.

Discussion: From submarine photos it would appear that 50% of Beach WHITE #2, particularly in the northern part, is studded with coral pinnacles and rocks, making a landing by LCVP's difficult if not impossible. These may also prove an obstacle to landings from LVT's. Four trails appear to leave the beach, the most southern being wide enough for single lane traffic. The most northern trail is an old 6 ft. railroad bed partially overgrown. The other two trails are merely footpaths.

WHITE Beach # 1 is very narrow and bordered on both sides by rocks. Directly in rear of the beach there appears to be an almost vertical cliff. Two paths lead inland from the top of the cliff, one a foot path and one about 8 ft. wide.

The only possible means of communication between Beaches WHITE # 1 and # 2 are cane roads which pass behind the enemy strong point situated on the cliff which separates the two beaches.

Behind Beach WHITE # 2 appears a narrow area of open cane fields which is terminated by a stretch of scrub covered land in which enemy installations are located. East of this scrub area, the terrain consists mainly of cane fields with some areas of scrub growth.

Positions which appear in this area are MG and medium AA installations with rifle pits, all located to target areas 639 Y and 632 E. The ridge overlooking the entire northern portion of the islands ends the cane area. It is tree covered and appears honeycombed with defensive installations. Seizure of this ridge appears essential if the airfield is to be taken.

The airfield, together with the taxi and building areas, are completely surrounded with defensive installations.

A resume of this study makes it apparent that if the enemy withdraws from the beaches, he can occupy prepared positions which dominate the entire airfield area.

3. ESSENTIAL ELEMENTS OF ENEMY INFORMATION:

a. To accompany WHITE BEACH Plan.

- (1) Are there any obstacles, (man made or natural) in addition to those previously reported on the WHITE BEACHES?
- (2) Will the enemy defend in force at the beaches?
- (3) Will the enemy defend at the beaches and withdraw to defensive positions on the ridge and west of the airfield?
- (4) Will the enemy move reserves from USHI POINT and/or TINIAN TOWN?
- (5) Has the enemy prepared additional defenses in the area between the beaches and the ridge and airfield area?
- (6) What additional installations has the enemy prepared along the ridge and west of the airfield?
- (7) Will the enemy employ tanks? If so where, when and what type?

APPENDIX III (b) TO ANNEX "BAKER"

2. ENEMY CAPABILITIES: TINTAN

a. GREEN and BLUE BEACHES.

(1) The enemy is capable of resisting at the beaches in force.

(2) The enemy is capable of defending TINTAN TOWN by house to house fighting.

(3) When forced to withdraw from TINTAN TOWN, the enemy is capable of defending from the high ground N of TINTAN TOWN to prevent movement to the new airfield.

(4) The enemy is capable of preventing our use of the facilities of TINTAN HARBOR by artillery fire from the plateau at the south end of the island.

(5) The enemy is capable of moving reserves from the north in 1-1/2 hours by marching, 30 minutes by motor.

DISCUSSION: GREEN BEACHES are in TINTAN TOWN and troops landing on them must be prepared immediately for street and house to house fighting in addition to opposition from numerous installations including pillboxes. Enemy troops forced from the town can withdraw to high ground overlooking the town from the north, thereby establishing a protective line in defense of the new airfield.

Altho clouds make study of the pictures of BLUE BEACH difficult, it appears that the north end of the beach contains coral heads and pinnacles which will make landings from LCV's extremely difficult if not impossible and landings from LVT's difficult. Photos of 18 April disclose little military activity in rear of the beach.

The plateau in the south of the island dominates both beaches, TINTAN Harbor, and TINTAN Town and must be reduced before either harbor or town can be used by our forces.

3. ESSENTIAL ELEMENTS OF ENEMY INFORMATION:

a. To accompany GREEN and BLUE BEACH Plan.

(1) Are there any obstacles (man made or natural) in addition to those previously reported on the beaches?

(2) Will the enemy defend in force at the beaches?

(3) Has the enemy prepared additional positions on the high ground north of TINTAN Town and between the town and new airfield?

(4) Has the enemy prepared additional positions on the plateau in the south of the island?

(5) Will the enemy move reserves from the north?

(6) Will the enemy employ tanks? If so where, when and of what type?

KELLEY
Cmdg

OFFICIAL:

McCaill

McCAHILL
S-2

S E C R E T

S E C R E T
AUTH: CG 27TH Inf Div
INITIALS:
DATE: 26 May 1944

RCT 165
APO # 27
28 May 1944

APPENDIX IV TO ANNEX "BAKER"
(For Opns Plans - GUAM)

2. ENEMY CAPABILITIES:

a. GUAM.

- (1) The enemy is capable of defending at the beaches with forces not engaged by 1st Prov Brig and the 2nd Marine Division.
- (2) The enemy is capable of defending on the beaches and then retiring to previously prepared but unlocated positions on the ridge 2000 yds in from the beach.
- (3) The enemy is capable of counter attacking with forces of unknown strength from the north at any time after our landing or counter attacking with troops disposed in positions along the ridge.
- (4) The enemy is capable of defending at the beaches and/or move reserves from the N, S, or E, to reinforce his beach defenses opposing our landing or employing these forces to counter attack.
- (5) The enemy is capable of opposing the landing by artillery fire from BARRIGADA MT. and from the airfield area.

DISCUSSION: There is a coral reef from 200 - 600 yds wide in the entire TUMON BAY BEACH AREA. This reef will probably prevent the use of any landing craft other than LVT's. However, there are approximately eight (8) openings in the reef each about 15 ft. wide which might be used.

Inland from the beach is a broad coastal plain about 2000 yds wide covered with coconut trees and scrub growth. This area is strongly defended with machine gun positions, rifle pits, pill boxes and tank traps, especially between the road paralleling the ridge and the beach. In addition it should be noted that at the ends of the beach appears YPAO PT. and GONGGA BEACH which present excellent flanking positions against troops landing in the bay. North of the eastern half of the airfield is a steep ridge. Air photos of 7 May do not disclose positions in the ridge itself other than what appear to be supply tunnels. However, it is possible that many positions are located here as the airfield is completely surrounded by positions of all types and is one of the most heavily defended areas of any of the islands. From this resume, it appears that the enemy plans to defend the beach area in strength and when driven from the beach, will defend the airfield very strongly.

BARRIGADA MT. (674') about 4000 yds south of TUMON BAY is the dominant terrain feature in this central GUAM area and must be taken to control the airfield and bay.

S E C R E T

APPENDIX IV to ANNEX "BAKER"

- 1 -

S E C R E T

AGANA RIVER basin, a low swampy area, E of AGANA TOWN will probably present a natural obstacle. Directly South of it there is a steep cliff which appears to be a natural defensive line for the enemy to use to prevent movement of our forces south.

3. ESSENTIAL ELEMENTS OF ENEMY INFORMATION:

a. To accompany Opns Plan 10 (landing behind marines)

(1) What is the enemy situation confronting the 1st Prov Brig and the 3rd Marine Division (reinf)?

(2) Where are the enemy reserves located?

b. To accompany Opn Plan 11 (landing behind marines)

(1) What is the enemy situation confronting the 3rd Marine Division (reinf) and the 1st Prov Brig?

(2) Where are the enemy reserves located?

c. To accompany Opn Plan 16.

(1) Are there any obstacles, (man made or natural) not previously reported along the reef and shoreline from YPAO PT to GONGGA BEACH?

(2) Will the enemy defend in force at the beach?

(3) Will the enemy delay at the beach and defend the high ground 2000 to 2500 yds inland?

(4) Will the enemy move reserves from the N, S, or E, when the threat at TUMON BAY develops?

(5) Are there any positions not previously reported on BARRIGADA MT.?

(6) Will the enemy employ tanks? If so where, when, and of what type?

KELLEY

Cmdg

OFFICIAL:

W. A. Hill
McCAHILL

S-2

SECRET

SECRET

39

AUTH: CG 27 Inf Div
INITIALS:
DATE: 28 May 1944.

RCT 165
APO #27
28 May 1944

ADM O NO. 1 to accompany Operations Plans

1. SUPPLY

a. Rations and forage:

(1) D-Day# thru D plus one (1) day:

(a) "K" rations - two (2) on each individual.

(b) Two (2) "D" rations, emergency reserve, in Bn DP's.

(2) D plus two (2) thru D plus eleven (11) days: Three (3) "K" and seven (7) "C" rations (shipped with each RCT).

(3) After D plus eleven (11) days:

(a) Truckhead distribution, RCT 165 supply dump, "B" rations.

(b) The schedule of distribution to be announced.

b. Water:

(1) D-Day# : Two (2) canteens on the individual.

(2) D plus one (1) days thru D plus two (2) days: from Battalion and Regimental dumps, approximately 2 1/2 gallons per individual per day. (Dumps established by the major unit commander from water cans shipped on each APA).

(3) D plus three (3) through D plus four (4) days: Truckhead distribution from reserve water DP under Division Quartermaster control. (Established from water cans shipped on the TransDivs) supplemented by water provided by Engineer distributing points.

(4) After D plus four (4) days:

(a) From water evaporators (distillating plants) installed by the Engineers, supplemented by local sources (purified by Engineer purification equipment): Water to be rationed by Engineers according to strength of unit.

(b) Emergency Reserve: Stored in canvas tanks installed adjacent to beach, filled by Engineers from ship's supply; established D plus one (1) day.

- D being D day for 27th Div.

SECRET

SECRET

c. Ammunition:

(1) Initial supply: Credit established for each organization to be drawn against for purposes of establishing combat loads and equipping individuals. (See Adm Memo No. 15, Hqs 27th Inf Div, 20 April 1944).

(2) During the initial phase, ammunition supply points will be established at the Battalion dumps, under control of the BLT Commanders ashore. These will be taken over from Battalion by Regimental personnel as soon as such personnel has landed.

(3) As soon as equipment is available, dumps will be established by RCT S-4 - location of which will be published in administrative overlays.

(4) ASP will stock all types of ammunition.

(5) RCT S-4 or Munitions Officer can be contacted at Service Company bivouac or RCT 165 CP.

(6) Unit Ammunition Resupply:

(a) Each Battalion and separate unit will submit a daily requisition covering their requirements for the next 24 hours by 1600, to the RCT S-4. This requisition may be in any form, but must be properly authenticated by either the Battalion Ammunition Officer or Battalion S-4. In the case of separate units, requisitions will be authenticated by unit commander. Proper nomenclature should be used to insure receipt of the right type of ammunition and fuzes.

d. Medical Supply:

(1) Initial medical supply from dumps established by major unit commanders, by each BLT on shore, from fifteen (15) days supply shipped on each APA (in accordance with 27th Division SOP, 12 October 1943).

(2) Reserve supply: Truckhead distribution from medical supply DP to be established in vicinity of Clearing Station.

e. Quartermaster Supply (including cleaning and preserving materials):

(1) Initial Supply: At least seven (7) days, carried by organizations.

(2) Reserve Supply: From QM DP, under Division QM control, from supplies designated as QM replacements, thru RCT S-4.

f. Engineer Supply:

(1) Introuching tools: An emergency supply from Engineer DP, established by the Shore Party Engineer Battalion, in vicinity of Shore Party Engineer Battalion CP.

(2) Engineer Equipment: Requested thru RCT S-4.

g. Signal Supply:

(1) Initial supply from 7-day stock on hand in each organization.

(2) Reserve supply from Division Signal DP: Requested thru RCT S-4.

h. CWS Supply:

- (1) Emergency gas masks from palletized gas masks with each BLT.
- (2) Other CWS supplies from Division CWO control: Requested thru RCT S-4.

i. Ordnance Supply:

- (1) Initial supply, at least seven (7) days, from stocks carried by units.
- (2) Reserve supply from Division Ordnance DP: Requested thru RCT S-4.
- (3) Maintenance: (all types)

(a) The general principle which will be followed will be to replace any equipment, which cannot be immediately repaired, with a serviceable item, and to return the unserviceable equipment to the Division Ordnance Field Shop where it will be repaired and put back into stock for reissue.

(b) The Division Ordnance Field Shop will be established in the vicinity of the Division CP, rear echelon. Its location will be clearly marked for easy identification and will be published in administrative overlays.

(c) This shop will be under the command of CO 727 Ordnance Company. It will accept any and all work brought in by any unit or individual.

(d) Contact parties, equipped to do on-the-spot repairs, will operate from this shop at frequent intervals to each infantry battalion and artillery installation.

(e) Trouble calls requiring immediate attention will be taken care of by special parties sent out from the Field Shop.

(f) When wire communication is established, the Field Shop may be reached by calling "CAMBER" thru the "CANARY" operator.

(g) If, for any reason, the Field Shop cannot be reached direct, trouble calls should be referred to RCT S-4, who will make sure that proper maintenance is provided immediately.

(4) Cleaning and preserving materials.

(a) All units will carry with them a 7 (seven) days' supply of cleaning and preserving materials in accordance with SOP for supply and evacuation (dated 12 October 1943).

(b) A dump for resupply of these items will be established at Division Ordnance DP. Each Battalion and separate unit will submit requisitions covering their requirements to RCT S-4. These requisitions may be in any form, but must be properly authenticated by either the Battalion Ammunition Officer or Battalion S-4. In the case of separate units, requisitions will be authenticated by unit commander.

(c) Contact parties, equipped to do on-the-spot repairs, who operate from the Division Ordnance Field Shop, will also carry small amounts of cleaning and preserving materials for emergency use.

(5) Bomb Disposal.

(a) All units and individuals are warned not to take any chances with dud bombs or projectiles. Notification of items of this type, with their general description and location, should be forwarded to the RCT S-4 at the first opportunity.

j. Logistical Control Group.

(1) The Logistical Control Group is responsible for the movement of all equipment and supplies to the beaches in the initial landing phase. All requests for supplies and equipment will come from the beaches directly to the S-4 representative on the Control Vessel. The S-4 representative will communicate directly with the floating dumps or with the ship, whichever the case may be, and order the supplies required to be sent in. No calls will go from the beach direct to the ships over the G-4 Administrative Net. All personnel, equipment, and supplies, will clear thru the Control Vessel before proceeding to the beach.

(2) The Headquarters Ship (Group Flag) will maintain a monitoring post for all of the frequencies in the G-4 Administrative Net and in case the Control Vessel is put out of action, will immediately take over control.

(3) The Logistical Control Group is established for the purpose of accomplishing the following:

(a) To prevent landing craft with supplies from approaching the beach before Shore Party is established or hydrographic conditions permit.

(b) To control the flow of essential supplies and materiel to the beach in the order in which it is required, preventing high priority equipment and supplies from being lost in milling landing craft off the beach.

(c) To insure that palletized equipment does not arrive at the beach until mechanical equipment is ashore.

(d) To process, thru Army channels, requests from Battalion S-4's for supplies or equipment and to expedite the movement of such materiel from the nearest available source by the most practicable means (landing craft or amphibious vehicles) direct to the Battalion Dump.

(e) To keep an Army record of the exact status of unloading with a view to being able to advise the Commander at any point whether critical materiel still remains aboard any craft.

(f) So that records may be kept of the status of unloading of each type of supply, Class I, II, III, and V, for each ship at all times.

(4) As each TransDiv has the potentialities for establishing three (3) independent beachheads, sufficient equipment and personnel will be supplied to operate the logistical control for this number. The organization for each TransDiv (RCT) for three (3) beachheads will consist of the following:

(a) On Board Control Vessel: Regimental S-4 representative, together with Regimental T-4, having with them complete stowage plans and manifests for all ships of the TransDiv together with two (2) radio operators.

(b) On Board the Flag-Ship of the TransDiv: An Ass't Regimental S-4 and two (2) radio operators whose purpose will be to expedite and transmit any requests from the Control Vessel for unloading any supplies from the TransDiv.

(6) Bulldozer to clear cemetery site will be provided by Shore Party Engineer as soon as practicable, on call from RCT Graves Registration Section, made thru RCT S-1.

(7) Sanitary detail, consisting of one (1) MAC officer and ten (10) specially trained enlisted men has been set up within each Medical Collecting Company to handle sodium arsenite spray for control of insect breeding. Each Collecting Company Sanitary Officer will report upon landing to RCT cemetery. Bodies will normally not be sprayed until arrival at cemetery, and after identification and preparation for burial has been completed by Graves Registration personnel. Use of detail for other purposes will be controlled by RCT Surgeon.

(a) Paragraph 3, Section IX, General Orders #5, Hqs 27th Inf Div, 17 January 1944, which provides for marking of bodies with yellow paint after spraying, will not be observed in this operation. If it is necessary to spray an isolated body or group of bodies, they will be suitably marked as having been treated with sodium arsenite, as will any foodstuffs sprayed by these details.

(8) Burial of enemy dead is a responsibility of Commanders within their zones of action. Personnel of 604th Graves Registration Company may not be utilized for this purpose.

d. Salvage:

(1) The collection of salvageable equipment, either our own or captured, will be the responsibility of BLT Commanders within their zone of action or within the area occupied by the unit.

(2) Initially: Salvage collection points convenient to supply dumps and routes of carrying parties returning to the rear will be designated by BLT Commanders or Separate Company Commanders and reported to appropriate supply agencies.

(3) If situation is such as to preclude immediate collections, a description and approximate quantity and location of salvageable supplies and equipment will be reported by the BLT and Separate Company Commanders to the RCT S-4. Such reports may be verbal; preferably, however, they will be written in the form of a rough sketch or overlay.

(4) As soon as Situation Permits: Equipment and supplies abandoned in battle or bivouac areas will be collected by the troops and returning hand carrying parties, and assembled in collecting points designated by RCT S-4.

(5) Salvage of individual weapons:

(a) Walking wounded will, if possible, carry their individual weapons.

(b) Litter-bearers will transport individual weapons on litter with wounded men whenever practicable.

(c) Weapons will be taken from wounded men at Battalion Aid Station and turned over to Battalion S-4.

e. Captured Materials:

(1) Any captured weapons, vehicles or ammunition should be reported, together with their location, to RCT S-4.

(2) After ship-to-shore movement is completed: Protracted convalescence expectancy (30 days or longer), military evacuation by troop collecting agencies through clearing agencies. Evacuation thereafter as feasible.

(3) Miscellaneous:

(a) All medical officers, regardless of tactical assignment, are charged with: Treatment and evacuation of casualties in their zone of operation.

(b) Shore party medical personnel: Responsible for treatment and evacuation of casualties occurring on the beach and for processing evacuated casualties, paragraph one above.

(c) The sorting of casualties by medical officers will be continual.

(d) Evacuation to departing ships: To the best interest of the casualty wherein this will include the maximum amount of surgical attention that can possibly be given at troop collecting and clearing stations.

(e) Evacuation policy: Not to exceed twenty-four (24) hours in any forward installation (forward of the Clearing Station).

(f) CP for Force Surgeon: Vicinity of first Clearing Station to be established - opens on shore same time as Clearing Stations.

c. Burial and Graves Registration.

(1) Except as noted below, procedure set forth in General Orders #5, Hqs 27th Inf Div, 17 January 1944, "SOP for Burial and Graves Registration", will be adhered to by all concerned.

(2) One section of the 604th Graves Registration Company is attached to RCT 165.

(3) Every effort will be made to minimize the number of cemeteries established. If an RCT lands on a separate beach, it will establish an RCT cemetery. If two RCT's land on adjoining beaches, a single cemetery will be established in the vicinity of the boundary between regiments, in a location to be established by G-4, 27th Inf Div. RCT sections from 604th Graves Registration Company will, in that event, be consolidated under the platoon commander, relieved from attachment to the RCT, and will function as personnel for the Division Cemetery. Responsibility of companies, battalions and regiments to evacuate dead to the Division Cemetery as set forth in Section III, General Orders #5, Hqs 27th Inf Div, 17 January 1944, will remain.

(4) First Lieutenant Thomas P. Fleming is designated as Summary Court Officer to function as Personal Effects Officer, and will set up to receive personal effects in the vicinity of the cemetery serving his RCT as soon as established.

(5) Care will be exercised to prevent unauthorized persons from removing any effects from the dead. Material which may be properly required for intelligence purposes is described in Intelligence Annex. Identification tags and personal effects will not be removed from American bodies except by Graves Registration personnel, other than in the case of isolated burials where necessary.

(f) All of the above will be established and operated by the RCT for the TransDiv which serves it.

(6) Divisional Operation:

(a) The Division G-4, with the Division TQM on board the Flagship of the Transport Group, will maintain a monitoring circuit for the RCT.

(b) The Division G-4, thru the monitor set, may be contacted at any time to assist the Regimental S-4, his assistants, or his TQM in the supplying of essential equipment or materiel from any of the other TransDivs, if the situation warrants.

(c) The Provisional Dulaw Company radios will be on the Division G-4 Common Net and may be dispatched to assist any of the RCT's in case of emergency. Initially, the Provisional Dulaw Company will be assigned to each of the TransDivs (as Dulaws are available) on the basis of one (1) Platoon for each TransDiv which is unloading (sixteen (16) Dulaws). NOTE: All Dulaws may not be available initially. When so assigned to TransDiv, Dulaws may be called on by Ass't Regimental S-4 from Control Vessel unless earmarked for other duties by G-4.

(d) As soon as the Division Command Post is established ashore, the Division G-4, taking with him one of the radio sets, will move to the CP, leaving an Ass't G-4 or the Division TQM, or both, to continue the operation of the Logistic Group.

(e) On the discharge of the TransDiv, the CO of the 1165th Engineer Group, the Division G-4, the Regimental S-4, the Shore Party Engineer Companies, all will continue to be tied in on the G-4 Administrative Net, using the same radio. Two (2) surplus radios (on the Flag-Ship) will be mounted in quarter-tons and used as G-4 may direct.

(7) Signal Plan: See attached sketched.

2. EVACUATION

a. Casualties:

(1) Personnel:

(a) Aid Stations upon landing: Follow their battalions in their zone of action.

(b) Collecting stations initially: Established by each provisional collecting platoon in the zone of action of its respective battalion in close proximity to beach.

(c) Clearing Station: Established immediately on landing (location to be announced). Clearing station opens one (1) hour after the landing of the initial elements of the Clearing Company or Field Hospital unit.

b. Evacuation:

(1) Sick and wounded during assault phase: Immediately to ship thru the Shore Party, except those of short convalescence expectancy (as determined by medical officers) who will be evacuated to assembly point, Clearing Station site.

(c) On the LST: Regimental S-4 representative with two (2) radio operators and SMU (1) Clerk to expedite requests received from the Control Vessel for amphibious vehicle or landing craft loads of critical supplies stowed on board the LST.

(d) With the Assault Battalion: The Assistant Shore Party Engineer Officer, together with sufficient enlisted men for reconnaissance of Beach dumps and sufficient personnel, specially trained, to assist the Navy in the survey of hydrographic conditions and the demolition obstacles off the beach. The Assistant Naval Beach Party Commander with sufficient personnel for survey of hydrographic conditions. The SPCT will furnish communication from the beach to the CP of Battalion Landing Team for the transmittal of supply requests. Initially, communication will be by radio and as the situation develops, by wire.

(e) On Call from the Control Vessel: The balance of the shore party, boated in anticipation of the call. A Boat pool, which shall consist of the following: Twenty (20) to twenty-five (25) boatloads, consisting of high priority combat supplies, and at least two (2) bulldozers (may be R-4's in LCVP's - D-7's in LCM's are preferred). These boats will circle in the vicinity of the Control Vessel, or in the location designated by the Control Vessel, until such time as they are called in to the beach by the Control Vessel.

(5) Regimental Operation: The general procedure will be as follows:

(a) The assault battalion, as it moves forward, will be tied into the Shore Party by radio. The wire will be laid by the SPCT when the situation allows.

(b) Assistant Shore Party Commander and Assistant Naval Beach Party Commander land in the early waves for the purpose of making reconnaissance and establishing communication, set up radio in the G-4 Administrative Net, and communicate with the Control Vessel. The Division G-4, with monitor set, listens in on early reports.

(c) Control Vessel takes the action indicated by the reconnaissance of the Assistant Shore Party Commander who will work closely with the Beach Party Commander and dispatches as early as possible:

1. The balance of the Shore Party.
2. The essential equipment in the Boat Pool.
3. Amphibious vehicle loads from the LST Floating Dumps as may be necessary to meet emergency needs.
4. Directs TransDiv to commence unloading supplies.

(d) When all emergency requests from combat troops have been met and TransDiv is discharging uniformly and there is no considerable congestion of landing craft, the Regimental TQM may then direct the Shore Party Commander to communicate directly with the AF or APA discharging across the beach (if there is only one) over the JASCO radio net, and the Control Vessel will then be cut out of the circuit except for monitoring.

(e) When the TransDiv is completely discharged, the TQM, S-4 representative, and the radio station on board the Control Vessel, may then go out of action. The radio and personnel will be transferred to the headquarters of the Regimental S-4 with whom communications will be maintained throughout the combat phase by means of the Administrative Radio Net.

- (2) Salvage procedure for enemy equipment similar to procedure for own equipment.
- (3) Any transportation coming to the rear will bring these items to the salvage dump, which will be established in the immediate vicinity of RCT DP.
- (4) Any items of this nature may be turned over to Division Ordnance Field Shop Contact Parties who will evacuate them to the Salvage Dump.

f. Prisoners of War:

- (1) Responsibility for evacuation of Prisoners of War: With subordinate commander to next higher headquarters.
 - (a) Initially: To the Prisoner of War Collecting Point with each Shore Party Engineer Battalion, located by prior coordination with CO, BLT. No prisoners of war will be evacuated to ships without prior approval of Division G-2. Troop Commander will arrange with Ship's Captain for those men of Ship's Party designated to guard POW's. After ship is unloaded this function should be taken over by crew.
 - (b) After ships depart: To Prisoner of War Collecting Point, location to be designated by 27th Division Provost Marshal as directed by higher headquarters.
- (2) Prisoner of War Collecting Points will be:
 - (a) Initially in the vicinity of each landing beach or group of landing beaches, established inclosure to be constructed by CO, Engineer Shore Party Battalion.
 - (b) Thereafter: Location to be announced.
- (3) Civilian casualties:
 - (a) Clearing Station will make provisions for the reception, care and treatment of civilian wounded.
 - (b) Civilian wounded will not, repeat not, be evacuated to ships.

3. TRANSPORTATION AND TRAFFIC

a. General: All transportation facilities, as soon as they deposit their initial combat load, will be pooled and controlled by the Senior Tactical Commander thru his designated Transportation Officer.

b. Circulation:

- (1) Main supply road to be designated.
- (2) Traffic priorities:
 - (a) Troop movements.
 - (b) Message Center and communication vehicles.
 - (c) Ammunition.
 - (d) Ambulances.

(c) Others.

c. Restrictions:

(1) Vehicular movement after darkness will be blackout as much as practicable consistent with safety.

(2) Provost Marshal, coordinating with BLT Commanders, will establish the forward limits of daylight traffic.

d. Control:

(1) Traffic control posts, when necessary, will be established by Division Provost Marshal.

(2) Control point for each BLT will be established in its zone of action by CO of BLT or his Transportation Officer for the operation and allocation of all the transportation - normally at each of the following:

(a) Beach.

(b) Beach dump area.

(c) Forward dump area.

e. Construction and maintenance of routes: See Annex No. 4 to Adm O #2, lqs 27th Inf Div, 5 May 1944.

4. SERVICE TROOPS AND TRAINS

a. All service troops temporarily attached to RCT's or BLT's will revert to senior officer of their branch of service on landing and will assemble at Beach Dump of their service.

5. PERSONNEL

a. Stragglers.

(1) Straggler collecting points: Initially established forward of each beachhead by Shore Party Engineers.

(2) Straggler Collecting Points and Straggler Line: to be announced.

b. Outgoing Mail.

(1) Outgoing mail, after being censored, will be forwarded thru companies, batteries, and detachments, to BLT, RCT, and MPO at Division CP.

(2) Incoming mail - reverse of above.

c. Casualty reports.

(1) In operations of the division, four consolidated casualty report forms will be used, entitled as follows:

(a) Battle Casualty Reports (CPA Battle Casualty Form No. 1).

(b) Non-Battle Casualty Report - Death (CPA Casualty Form 2A).

(c) Missing Reports (Missing (Non-Battle) and Missing in Action (Battle) Report). (CPA Casualty Form 3).

(d) Seriously Ill or Injured (Non-Battle Casualties). (CPA Casualty Form 2B).

(2) The Personnel Officer of Regiments, Separate Battalions and Separate Companies will prepare the forms listed above.

(3) The following procedure will be used in the preparation of these reports.

(a) The Battalion surgeon or Unit surgeon will prepare two copies of CR 5 Daily Medical Casualty Report and submit one copy to the Personnel Officer of separate organization thru Battalion or Unit Commander and the other copy, accompanied by the duplicate EMT's for those casualties other than his own organization, to the Medical Section, Hqs 27th Inf Div, thru Medical Channels. The Personnel Officer will then prepare the appropriate report from information listed in Daily Medical Casualty Report (CR 5). Forms listed in paragraph 1 will be prepared in accordance with instructions contained in letter, HCPA, dated 14 January 1944, file AG 704, subject, "Instructions for Submitting Battle and Non-Battle Casualty Reports and Missing Air Crew Reports", and letter, HCPA, dated 21 March 1944, file AG 704, subject, "Instructions for submitting Battle and Non-Battle Casualty Reports".

(b) Seriously injured cases will be reported on appropriate forms listed in Paragraph 1a and 1d to Hqs 27th Inf Div daily covering the period 1800-1800.

(c) Missing report will be filled out by checking the morning report against the Daily Medical Casualty Report. Personnel unaccounted for will be classed as Missing in Action, or Missing. This report will be submitted to Hqs 27th Inf Div daily covering the period 1800-1800. AG will notify organizations concerned of disposition of casualties treated by other organizations.

(d) On all seriously wounded, ill, or injured personnel where there is a definite change in the status of the man concerned, progress reports will be submitted in duplicate by surgeon attending. One copy will be forwarded to the Personnel Officer, who in turn will submit a report to Hqs 27th Inf Div, as outlined by paragraph 8c (1), Circular No. 195, War Department, 1943; the other copy will be forwarded, thru Medical Channels, to the Medical Section, Hqs 27th Inf Div.

(4) Personnel Officer will retain copies of Daily Medical Casualty Report as part of his permanent record for the purpose of establishing a basis for awards and decorations.

(5) During combat, Strength and Casualty Reports will be submitted daily as of 1800 to cover the twenty-four (24) hour period immediately preceding the date and time of the report so as to reach the Regimental Adjutant at the earliest practicable time on the morning of the following day. Strength and Casualty Report forms recently distributed will be used for this purpose. First report will be prepared at 1800 on D minus 1 Day and submitted with report covering up to 1800 on D Day. In the event that casualties are suffered due to enemy action, or for any other reason, prior to D minus 1 Day, report will be prepared and submitted with D minus 1 Day report.

d. Miscellaneous administrative matters: See following:

(1) Individual equipment and Personal Items: Circular 44, 27 April 1944 and Adm Memo #11, 13 April 1944.

(2) Prescribed Loads of Ammunition: Adm Memo #15, 20 April 1944.

(3) Rear Echelon and Storage of Equipment: Adm Memo #17, 4 May 1944.

(4) Manifests UP & T Tables: Adm Memo #2, 18 January 1944.

KELLEY
CMDG

OFFICIAL:

LOTZ
S-4

1 Incl:

G-4 Administrative Net

DISTRIBUTION: See Distribution List

S E C R E T

39

S E C R E T
AUTH: CG 27TH Inf Div
INITIALS:
DATE: 25 May 1944

RCT 165
APO 27
26 May 1944

ANNEX "HOW" to accompany FO # 10

PASSWORD AND COUNTERSIGN

1. In order to eliminate possible confusion and to facilitate rapid recognition between members of different organizations within Expeditionary Troops, the following system of passwords and countersigns will be employed by all units under this Command.
2. Three key words are assigned and each word will be used for a period of five (5) consecutive days. The password will be changed at 1200 local time on the 6th Day.
3. At the end of the period, the system will be repeated, starting at 1201 local time on the 16th Day.
4. Below are listed the key words and the periods of time for which each will be used:

	<u>KEY WORD</u>
1st day, starting with D-day, through 1200, 6th day.	Months of the year.
1201, 6th day, through 1200, 11th day.	Cities of the U.S.
1201, 11th day, through 1200, 16th day.	States of the U.S.

The challenge, "Halt, who is there?" will be employed.

EXAMPLES:

First 5-day period beginning with D-day (Months of the year).

Challenger: Halt, who is there?

Answer: July (or any other month of the year).

Challenger: April (or any other month of the year).

Second 5-day period beginning at 1201 local, 6th day (Cities).

Challenger: Halt, who is there?

Answer: New York (or any other large city of the U.S.)

Challenger: Los Angeles (or any other large city of the U.S.).

S E C R E T

S E C R E T

S E C R E T

S E C R E T

Third 5-day period beginning at 1201 local, 11th day (States).

Challenger: Halt, who is there?

Answer: Missouri¹ (or any other state of the U.S.).

Challenger: Texas (or any other state of the U.S.).

5. All personnel will be warned that in no case will this code be taken ashore. It must be borne in mind that it is only necessary to memorize the key word corresponding to each 5-day period.

KELLEY
Cmdg

OFFICIAL:

McCahill
McCAHILL
S-2

S E C R E T

ANNEX HOW

-2-

S E C R E T

39

AUTH: CG 27 Inf Div
 INITIALS: SL/6
 DATE: 28 May 1944.

RCT 165
 APO # 27
 28 May 1944.

ANNEX "FOX" to accompany FO # 10

SPECIAL LANDING INSTRUCTIONS

1. a. Landing plans described herein are based on the following considerations.

(1) That enough LVT's will be available to land two (2) BLT's in assault. (Plan ABLE).

(2) That no LVT's are available and landings will be made in landing craft from TransDiv 32 plus additional craft loaned by TransDiv 34 (Plan BAKER).

2. Plan ABLE - Landing in LVT's:

a. This plan provides for:

(1) Landing two (2) assault BLT's of RCT in not to exceed eighteen (18) LVT's per wave.

(2) Seizing a beach head sufficiently large to permit deployment of assault BLT's on the ground.

(3) A perimeter defense to cover:

(a) Mopping up opns.

(b) Landing of reserves.

(c) Reorganization prior to advance.

b. (1) Landing Plan ABLE is a method of landing assault elements of two (2) BLT's abreast so as to gain maximum shock effect and to place the largest number of combat trs ashore in a minimum of time.

(2) BLT Cmdrs will prescribe the allocation of LVT's, formations and scheme of maneuver so as to execute the concept of the above landing plan.

(3) During assault, wpns will be fired by first wave when LVT's are within effective range.

(4) BLT Cmdrs will select a tractor line that initial assault elements should be able to reach before debarking. Where possible, this line will coincide with initial objective, usually A-1.

(5) It is contemplated that LVT(A)(1)'s upon reaching objectives, may be ordered to remain to assist in covering opns of support and res units. LVT (A)(1)'s if employed, will be the first wave and between 8 and 10 will be supplied each BLT.

(6) LVT's returning to beach from inland will in general, and if terrain permits, move along flanks of Bn beach head. BLT Cmdrs prescribe and enforce exact routes. Cargo LVT's, except those designated to remain on beach, will return promptly to control vessel for further employment.

(7) LVT's contemplated for use by CT 165 will already have been used by Marine assault trs. Identification markings on those vehicles - a one foot colored stripe painted on each side and on the stern - will not be used by CT 165. Boat signs as prescribed in TM # 53, Hq 27th Inf Div, 27 Apr 44, will be used. Boat Cmdrs must instruct vehicle drivers not to follow original markings.

(8) When vehicles have to be abandoned, all ammunition will be removed and weapons removed or destroyed.

3. Plan BAKER

It is possible that a limited number of LVT's will be available to supplement LCV's and LCM's. They will be employed in landing waves.

4. Boat Availability

a. Plan ABLE:

	LVT(2)	LVT(4)	LCM	LCV(P)
BLT 165-1	52	8	6	
BLT 165-2	55	8	5	
BLT 165-3	--	-	5	32
Cn Co - AUREGA			2	
Cn Co - FREMONT			3	
RCT Hq				2
Div Hq				4

b. Plan BAKER:

	LCM	LCV(P)
BLT 165-1	6	35
BLT 165-2	5	35
BLT 165-3	5	32
Cn Co AUREGA	2	
Cn Co FREMONT	3	
RCT Hq		2
Div Hq		4

5. Minimum interval between landing craft:

- LVT's - 40 yds
- LCV(P)'s and LCM's - 50 yds

6. Priorities of Landing 2nd Trip of Boats:

- Balance of assault Bn's.
- Plat Co C 88th Cml Mort Bn
- Balance RCT Troops.
- Div Troops.

SECRET

-3-

SECRET

c. Reserve BLT (Will become 1st Priority immediately upon receipt of order for landing.

KELLEY
CMDG

OFFICIAL :

Seater
COATES
S-3

SECRET

ANNEX FOX

-3-

SECRET

S E C R E T

S E C R E T

HEADQUARTERS 27TH INFANTRY DIVISION
A.F.O. 27

9 May 1944

MEMORANDUM:

TO : All Officers.

MAP CORRECTION - SAIPAN

1. MAP - SHEET 2, SAIPAN-TINIAN AREA, scale 1/20,000.
2. BLACK Beaches No. 1 and No. 2 will be changed as shown on sketch below and **renumbered** as noted.
3. This information will be thoroughly disseminated to all personnel issued this map. A complete check will be made to make certain that all maps are corrected.

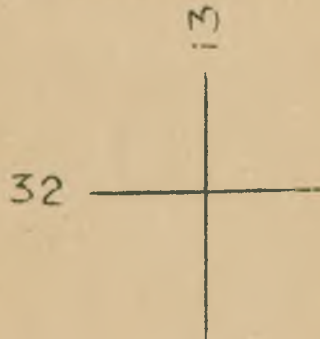

H N

W. M. Van Antwerp
 W. M. VAN ANTWERP,
 Lt Colonel, GSC,
 AC of S, G-2.

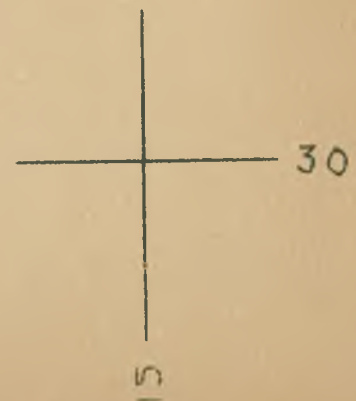
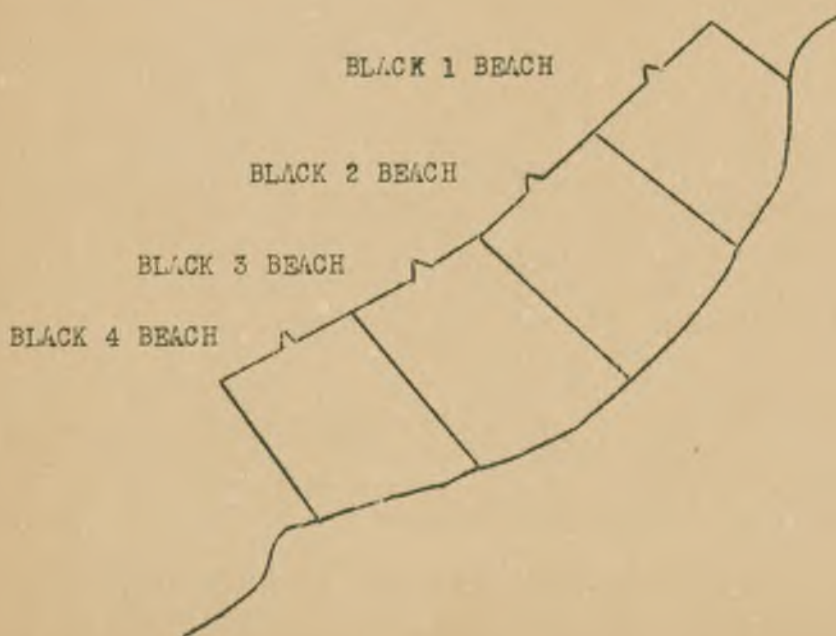

S E C R E T

S E C R E T

39

AUTH: CG 27 Inf Div
 INITIALS: Q/L
 DATE: 28 May 1944.

RCT 165
 APO # 27
 28 May 1944.

ANHEK "GEORGE" to FO # 10 - FORAGER.

SIGNAL COMMUNICATIONS PLAN

The following communications plan will be in effect during the operation and will not be taken forward of the BLT CP.

1. Time: Local time (Ship's time) will be used in all messages within the RCT. GREENWICH or ZONE Time will be used in all messages to units higher than Division. Time signals will be broadcast daily at 0700, local time, via radio and telephone to all BLT Msg Cen's. Msg Cen's will be responsible for keeping the correct time.

2. Radio:

a. Absolute radio silence will be maintained while afloat until HOW Hour minus four (4) hours. At this time or other specified time, all radio stations required for operation at HOW Hour will establish a listening watch but will not transmit. All calibration checks and dial settings will be made prior to debarkation.

b. To expedite transmission, message writers and users of radio will write messages with a view towards transmission of the message in the clear. The SCR 300 radio will operate continuously from HOW Hour, using call signs and frequencies assigned in landing boats and during movement of CP's.

c. Radio Nets and Frequencies:

(1) 1-A 27th Inf Div Command Net

	<u>Call Sign</u>	<u>Call Word</u>	<u>Freq</u>
Hq 27th Inf Div	7ML	Rankle	5540 kc
CG 27th Inf Div	7MF	Rancid	
Asst Div Cmdr	7UV	Sackbutt	
105th Inf Regt	7MP	Raspberry	
106th Inf Regt	7OB	Redundant	
165th Inf Regt	7PT	Rhode Island	
Div Arty Hq Btry	7RA	Riot	

(2) 1-B 27th Inf Div Command Net

Call signs and units the same as Net 1-A but frequency is 5420 Kc.

(3) Net 5 - 27th Inf Div G-4 Adm (common): 27.5 Channel B

G-4 27th Inf Div	Rankle	SCR 510
Asst G-4 27th Inf Div	Rankle Wun	
G-4 on Control Boat	Rankle Too	
S-4 105th Inf Regt	Raspberry	
S-4 106th Inf Regt	Redundant	
S-4 165th Inf Regt	Rhode Island	

(4) Net 5-C - 165th Inf Regt S-4 Net : 25.1 Channel A

S-4 165th Inf Regt (Capt Kenny)	Rhode Island	SCR 510
Asst S-4 165th Inf Regt	Rhode Island Wun	
RCT TQM aboard control boat)	Rhode Island Too	
S-4 BLT 165-1	Ribald	
S-4 BLT 165-2	Ribroast	
S-4 BLT 165-3	Ricardo	

(5) Net 19 - 165th Inf Regt Command Net - Freq 5285 Kc

SCR 284

Hq 165th Inf Regt	7PT	Rhode Island
BLT 165-1	7PZ	Ribald
BLT 165-2	7QA	Ribroast
BLT 165-3	7QC	Ricardo
Serv Co 165 Inf Regt	7VG	Saginaw

(6) Net 20 - 165th Inf Special Purpose Net: Freq 4590 Kc

SCR 284

Hq 165th Inf Regt	7PT	Rhode Island
A-T Co 165th Inf Regt	7QM	Ridley
Cn Co 165th Inf Regt	7QJ	Ridgopole
I & R Plat 165 Inf	7QZ	Ringworm

Note: This net will operate on special missions only, and will be coordinated through this hq. This frequency will also serve as an alternate frequency for the Regtl Command Net.

(7) Net 21 - 165th Inf Regt Voice Net - Freq 40.8 Mc

Channel 4

SCR 300

Hq 165th Inf Regt	Rhode Island
BLT 165-1	Ribald
BLT 165-2	Ribroast
BLT 165-3	Ricardo
Serv Co (S-4) 165 Inf	Saginaw

- (8) Net 21-A - I & R Plat Net: 46.4 Mc Channel 32
SCR 300
Hq I & R Plat Ringworm
- (9) Net 21-B - A-T Co Net: 47.6 Mc Channel 38
SCR 300
Hq A-T Co 165 Inf Ridley
- (10) Net 21-C - Cn Co Net: 40.0 Mc Channel 0
SCR 300
Cn Co 165th Inf Ridgopole
- (11) Net 21-D - Cn Co Net: 26.7 Mc Channel A
SCR 510
Hq Cn Co 165th Inf Ridgopole
- (12) Net 22 - BLT 165-1 Net: 42.4 Mc Channel 12
SCR 300
Hq BLT 165-1 Ribald
Co A Ribald Able
Co B Ribald Baker
Co C Ribald Charlie
Co D Ribald Dog
S-2 BLT 165-1 Ribald Too
CO BLT 165-1 Ribald Six
1st Plat AT Co 165 Inf Ridley Wun
1st Plat Cn Co 165th Inf Ridgopole Wun
- (13) Net 23 - BLT 165-2 Net: 44.0 Mc Channel 20
SCR 300
Hq BLT 165-2 Ribroast
Co E Ribroast Easy
Co F Ribroast Fox
Co G Ribroast George
Co H Ribroast How
S-2 BLT 165-2 Ribroast Too
CO BLT 165-2 Ribroast Six
2nd Plat AT Co 165 Inf Ridley Too
3rd Plat Cn Co 165 Inf Ridgopole Thuh-ree
- (14) Net 24 - BLT 165-3 Net: 45.2 Mc Channel 26
SCR 300
Hq BLT 165-3 Ricardo
Co I Ricardo Item
Co K Ricardo King
Co L Ricardo Love
Co M Ricardo Mike
S-2 BLT 165-3 Ricardo Too
CO BLT 165-3 Ricardo Six
3rd Plat AT Co 165 Inf Ridley Thuh-ree
- (15) Net 22-A - Co A Net Ribald Able: 3885 Kc SCR 536

- (16) Net 22-B - Co B Net Ribald Baker: 5437.5 Kc SCR 536
- (17) Net 22-C - Co C Net Ribald Charlie: 4930 Kc SCR 536
- (18) Net 22-D - Co D Net Ribald Dog: 4840 Kc SCR 536
- (19) Net 23-A - Co E Net Ribroast Easy: 4035 Kc SCR 536
- (20) Net 23-B - Co F Net Ribroast Fox: 4080 Kc SCR 536
- (21) Net 23-C - Co G Net Ribroast George: 5327.5 Kc SCR 536
- (22) Net 23-D - Co H Net Ribroast How: 5500 Kc SCR 536
- (23) Net 24-A - Co I Net Ricardo Item: 5205 Kc SCR 536
- (24) Net 24-B - Co K Net Ricardo King: 4280 Kc SCR 536
- (25) Net 24-C - Co L Net Ricardo Love: 5397.5Kc SCR 536
- (26) Net 24-D - Co M Net Ricardo Mike: 4397.5 Kc SCR 536

d. On Nets 21-A,B,C and D; 22-A,B, C and D; 23-A, B, C and D; 24-A, B, C and D; the platoon calls will be formed by adding Wun, Too, Thuh-rec, etc. to the voice call of the parent organization. Shore Party calls will be formed by adding Peter to the voice call and "P" to the CW calls of the BIT to which atchd. Rear Echelons will add "Rear" to the voice call and "R" to the CW call of their unit call. Adv Msg Cen's will form calls by adding "X-ray" to the voice call and "X" to the CW call. No other call words or signs will be used by any net in this unit without approval from this hq.

e. Shore Party Com Nets:

- (1) RCT 105 Raspberry Peter 5730 Kc
- (2) RCT 106 Redundant Peter 5315 Kc
- (3) RCT 165 Rhode Island Peter 5580 Kc
- (4) Lateral Beach 5315 Kc

f. Authenticators will be used on all nets when station initially reports into the net, and at any time any station believes his messages are being intercepted.

g. All reports of interference, interception, or jamming of radio nets will be reported to the RCT Cmdr immediately.

h. Ship's names will not be used on the air. If reference must be made to a ship the following code words will be used:

<u>SHIP</u>	<u>VOICE CALL</u>
APA 2, HARRIS (RCT 165 & BLT 165-1)	Tombstone
APA 40, CUSTER (BLT 165-2)	Hardtack
APA 44, FREMONT (Hq 27 Inf Div)	Boomerang
APA 173, HERALD OF THE MORNING (BLT 165-3)	Cloudbreak
AK 98, AUREGA	Burgundy

3. Visual:

a. Panels: CCBP 8 in effect.

b. Add to vocabulary, part II, CCBP 8, under "Information, Enemy Action":

<u>Panel Display</u>	<u>Meaning</u>
57	Enemy concentration
58	Enemy auto wpns
59	Enemy arty

c. (1) The yellow side of the fluorescent panels AL-141 will be used to mark front lines when so requested.

(2) Two (2) or more violet, red, or yellow smoke grenades will be used to mark front lines when ordered by BLT or RCT Cmdr's.

d. Tanks: Tanks will display flags on turrets denoting the following:

<u>Flag</u>	<u>Meaning</u>
Orange	Tank is low on ammo, fuel; is pulling back to replenish supplies, will return.
Green	Request telephone com with grd trs. Telephone is located in box in rear of tank near left tread.

e. Pyrotechnics:

(1) When fired by ground troops:

<u>Pyrotechnic</u>	<u>Meaning</u>
1. White Star Parachute	Illumination only
2. White Star Cluster	To be assigned.
3. Green Star Parachute	To be assigned.
4. Green Star Cluster	Arty or bombs falling within our lines.

c. (1) Cont'd.

<u>Pyrotechnic</u>	<u>Meaning</u>
5. Amber Star Parachute	Assault waves have landed.
6. Amber Star Cluster	Objective taken.

Note: Number 2 through 6 must be repeated at least once.

(2) When fired by aircraft:

<u>Pyrotechnic</u>	<u>Meaning</u>
1. Two (2) Green Stars	My mission completed.
2. Two (2) Red Stars	Display front line panels.
3. White Flare Parachute	Assault troops 500 yds from the beach.

Note: The Number One (1) Signal, above, "My mission completed," will be given by the last plane in the last group to participate in the particular mission at the time the last bomb is released.

(3) Smoke Grenades:

<u>Color</u>	<u>Meaning</u>
One (1) Red	Friendly troops or patrol returning.
One (1) Orange	Naval gunfire cease or shift to other targets.
One (1) Green	SOS or "Patrol needs aid".

f. Air Raid Warnings:

<u>Visual</u>	<u>Radio (inclear)</u>	<u>Meaning</u>
Zebra Flag	Flash Red	Air atk imminent.
Two (2) Pennants	Flash Blue	Air atk probable.
One (1) Pennant	Flash White	All Clear.

Ten (10) seconds blast with five short intervals for a period of two (2) minutes on siren from base or senior ship in harbor denotes air raid.

g. Control of Anti-aircraft fire:

<u>Visual</u>	<u>Radio (inclear)</u>	<u>Meaning</u>
Green Flag	Control Green	All guns hold fire.
Yellow Flag	Control Yellow	All guns fire.

4. Codes and Ciphers:

- a. Combined Assault Code CCBP 0130-1, plus Addendum of CentComTwo will be primary cryptographic system.
- b. Hagelin Key List No 7, CSP 1500 or M209 is the secondary cryptographic system. Keys will be changed daily by Zone Zero dates at 0000 GCT daily.
- c. Shore Fire Control Code CSP 2156B plus Addendum of CentComTwo will be used by Shore Fire Control Parties.
- d. Shackle Code will be used to encode numerals rapidly as per par 6631, Annex "G" CentComTwo. Extracts of this will be made and given to Companies by BLT Com O's.
- e. Shackle Authenticator System will be used to authenticate on radio nets per par 2400 CentComTwo. List of effective words is in par 6631 CentComTwo. Extracts will be made and given to Companies by BLT Com O's.
- f. Prearranged message Code will be used to the fullest extent for expediting messages.

5. Wire Communication:

- a. Wire will be laid by BLT's to Shore Party Swbd's from inland BLT CP's. RCT Com Plat will use these lines in establishing RCT CP ashore, and will establish circuits to the beach and to the BLT CP's.
- b. Lines will be elevated from the ground as soon as possible.
- c. Units will tag all lines as follows:
- | <u>Unit</u> | <u>Tag</u> |
|-------------|------------|
| RCT 165 | Green |
| BLT 165-1 | Red |
| BLT 165-2 | White |
| BLT 165-3 | Blue |
- d. Lines will be simplexed for telegraph operation no phantom circuits will be used unless authorized by this hq.
- e. Line Route Maps and Circuit Diagrams will be turned in to this hq by 1200 local time, daily.
- f. Telephone Directory: Par 4300, 4320, Annex "G" CentComTwo.

6. Officer's Call Names:

- a. To prevent violation of radio security and for calling

6. a. Cont'd.

individual officers by radio or telephone the following list will be used:

<u>Title</u>	<u>Telephone No</u>	<u>Radio Call Words</u>
G-1 (S-1)	One	Sugar One
G-2 (S-2)	Too	Sugar Too
G-3 (S-3)	Thuh-ree	Sugar Thuh-ree
G-4 (S-4)	Fower	Sugar Fower
Exec O	Fi-yiv	Fi-yiv
CO	Six	Six
Com O	Wun Zero	Wun Zero
Msg Con	Wun Wun	Wun Wun
Air O	Wun Fower	Wun Fower
Engr O	Wun Fi-yiv	Wun Fi-yiv
Surgeon	Wun Six	Wun Six
Chaplain	Wun niner	Wun niner
Arty O	Too Too	Too Too
Gas O	Too Thuh-ree	Too Thuh-ree
Munitions O	Too fi-yiv	Too Fi-yiv
Radio Station	Too ate	Too Ate
Rcn O	Too niner	Too Niner
Wire Chief	Thuh-ree Wun	Thuh-ree Wun
Hq Cmdt	Thuh-ree Fower	Thuh-ree Fower
Motor O	Thuh-ree Fi-yiv	Thuh-ree fi-yiv
AT O	Thuh-reeSix	Thuh-ree Six
SSO	Thuh-ree Seven	Thuh-ree Seven
TQM	Thuh-ree niner	Thuh-ree Niner

b. When using telephone denote the switching central before the officer's designation; i.e., Calling S-4 165th Inf ask for Castor Fower.

c. When using radio precede the officer's call sign by the station call sign; i.e., When calling S-4 165 Inf ask for Rhode Island then for Sugar Fower. All users of radio are warned not to use the proper names of officers on radio nets.

d. Line Companies will use Wun, Too, Thuh-ree and Fower to designate their respective platoon leaders, fi-yiv to designate the Exec O and Six for the CO.

7. Message Center:

Message Centers will be responsible for keeping the correct time, they will be prepared to furnish messenger service as soon as possible. Schedule message center runs will be established as soon as possible.

8. Messengers:

Two (2) messengers from each BLT will report to the RCT CP ashore as soon as it is established. One (1) messenger will be sent to the RCT CP from Cn Co, AT Co, Serv Co and attached units as soon as their CP's are established ashore.

KELIEY
CMDG

OFFICIAL :

COATES
S-3

SECRET

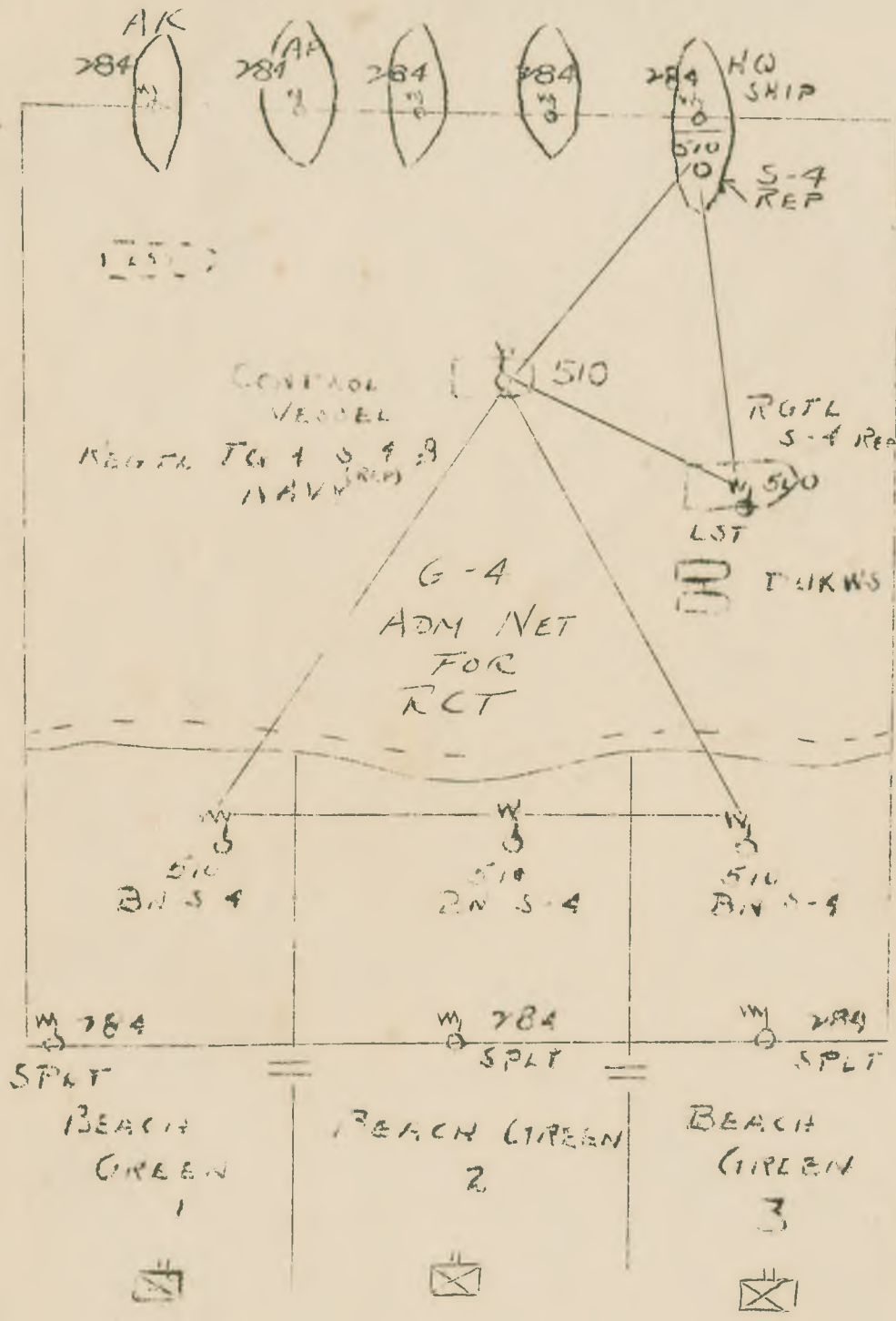

SHORE FTY COM TEAM SHIP TO SHORE NET

BEACH GREEN

S E C R E T

S E C R E T

REF: CG 27 Inf Div
INITIALS: *AK*
DATE: 30 May 1944.

CG 27 103
CG 27
30 May 1944.

.....ll)

1. The following movement table will govern troop movement on 31 May 44.

MOVEMENT TABLE

	USS FRANLIS	USS CUSTER	USS H of the M	USS FREEMONT	USS AURIGA
Time of assembly	1000	1030	1100	1100	1130
Assembly Area	Quad E	Post Thea Park Lot	Quad E	Quad E	Post Thea Park Lot
Time of Departure	1100	1130	1200	1200	1230
Point	Railroad track at Post Theatre Parking Lot				Post Thea Park Lot
Number of Cars	34	28	28	16	
Train No	1	2	3A	3B	Serial # 1
Floor	AREA Lndg X-Ray 9	PH S-21	PH S-21	PH S-21	PH 24
Estimated Time of arrival	1300	1330	1400	1430	1330
Train Cmdr	Maj Mahoney	Lt Col McDonough	Maj Claire	Maj Claire	Capt Marshall

2. Uniform: M1, Loggings, Helmet, Individual Equipment.

By order of Colonel KELLEY:

OFFICIAL :

Charles E. Coltes Jr.
CHARLES E. COLTES JR.
Captain, 165th Inf,
S-3

S E C R E T

S E C R E T

Sgt. Draper

19

MESSAGE

MEANING

PB	(PLACE)*	Alert your command for movement to (PLACE)
PC	(CALIBER)	Ammunition needed (CALIBER)
PE		Are you in contact with
PG		Artillery
PI	(TIME)	Attacked at (TIME)
PK		Battalion
PM	(TIME) (PLACE)*	Being attacked (TIME) by () (PLACE)
PO	(TIME)	Commanders report to CP for orders at (TIME)
PQ		Continue Attack
PR	(TIME) (PLACE)*	Counter attack at (TIME) (PLACE)
PS	(PLACE)*	Counter attacking forming at (PLACE)
PU	(PLACE)*	CP located at (PLACE)
PW	(NUMBER)	Dead, ours (NUMBER)
PY		Division
QA		Enemy
QC	(PLACE)*	Enemy anti-tank mine field found at (PLACE)
QE	(PLACE)*	Enemy resistance strong (PLACE)
QG	(PLACE)*	Enemy resistance weak (PLACE)
QI	(TIME)	First wave landed Beach (NAME) at (TIME)
QK	(PLACE)* (TIME)	Front line located (PLACE) (TIME)
QM	(TIME) (PLACE)*	Have committed reserve at (TIME) (PLACE)
QO	(TYPE) (PLACE)*	Hold up by (TYPE) fire at (PLACE)
QP		I am in contact with
QQ	(PLACE-S)* (TIME)	In position at (PLACE-S) (TIME)
QS		Landing successful
QU		Landing unsuccessful
QW		Machine gun
QY		Mortar
RA		No resistance my front (RIGHT) (CENTER) (LEFT)
RC	(PLACE)*	CP Located at (PLACE)
RE		Regiment
RG		Report present disposition
RH		Request identification of units opposing you
RK		Tanks
RM	(TIME)	Time of attack (TIME)
RO		Unidentified
RQ		Water needed
RS	(NUMBER)	Wounded, ours (NUMBER)

*Place will be indicated by "M" grid coordinates.